

LAUNCH
OFFER - BOOK
EARLY AND SAVE
£500
PER PERSON

PASSAGE TO KAMCHATKA & BEYOND

AN EXPEDITION CRUISE FROM JAPAN TO ALASKA EXPLORING
THE RUSSIAN FAR EAST ABOARD THE SILVER DISCOVERER

23RD JUNE TO 13TH JULY 2016

NOBLE CALEDONIA

Silver Discoverer and brown bear



The remote reaches of Russia's Kamchatka Peninsula and the distant and isolated Kuril Islands have fired the imagination of explorers and traders for centuries. Join us on this remarkable voyage of unparalleled exploration as we follow in Bering's path along the 'Pacific Ring of Fire', a region known to only a few privileged travellers. From Hakodate, Japan through Russia's Kamchatka Peninsula to Alaska, we cruise through a pristine environment that calls to nature lovers, history buffs, photographers and the intrepid explorer within.

Among the Kurils, a necklace-like chain of volcanic islands, we find a staggering abundance of marine life, vast forests and wild-flower-dappled tundra, back-dropped by soaring steam-breathing volcanoes. Basalt stacks rise from the sea, tailor made resting and nesting spots for unimaginable numbers of seabirds. Reaching the Kamchatka Peninsula, Russia's remote easternmost province and home to the brown bear, we are greeted with a dramatic landscape of fire and ice. Geysers, hot springs and active volcanoes set amidst towering mountains and fast flowing rivers make this area magnificently unique. Marvel at spouting whales, frolicking seals and huge populations of nesting and migratory seabirds. Sailing in late June and early July, we will take full advantage of the mid-summer sun, travelling on nature's terms, enjoying dramatic scenery and encountering the region's ancient cultures and fascinating people whose lives are rarely touched by outsiders.

Few places in the world can offer experiences beyond one's imagination. But here, as we navigate along the Kamchatka Peninsula with its spectacular scenery and skies dominated by vast colonies of seabirds, we can enjoy one of the last true wilderness areas. The wildlife is some of

the richest in the world and the region is truly a birdwatcher's paradise with Tufted and Horned puffins, guillemots, cormorants, Steller's sea eagle, Brown-headed Thrush, Siberian Rubythroats, Black legged Kittiwakes, and Crested or Whiskered Auklets just some of the species we hope to encounter. In fact, over 150 different bird species were spotted during our last voyage in the region and a full list is available on request.



Tufted puffin

Using our Zodiacs to make landings, we hope to catch glimpses of brown bear and countless seabirds will accompany us as we cruise in comfort aboard the luxurious Silver Discoverer. This is your opportunity to see a seldom visited corner of the world and the chance to witness the timeless processes of nature taking place without the hindrance or help of man. We will discover remote, forgotten places that are rich in wildlife, culture and history. With our fleet of Zodiac landing craft we can explore inlets, bird sanctuaries and land in otherwise inaccessible places and although we set sail with a set itinerary, it is often the unscheduled events that become the highlight.

We will be joined onboard by an expert expedition team composed of experts in the culture, history and wildlife of the Russian Far East including historians, geologists, ornithologists and botanists. The expedition team will add greatly to your experience through informal talks onboard, guided Zodiac landings and during the small group explorations ashore. The daily programme will be in the capable hands of the Expedition Leader who will coordinate with the Captain and Officers onboard to make the most of each day, the weather and wildlife sightings.



Zodiac cruising at Listvenichnaya Bay

SHIP'S LOG

We have operated many similar voyages and below are extracts from past ship's logs which should provide you with an insight into what you can expect from this unique voyage...

Tyulenyi Island, Sakhalin:

"Approaching the beach we could already see incredible wildlife. Guillemots were all around on the water and in the air and the beach and the shallows near our landing site was dotted with truly enormous Steller sealion bulls, and smaller (but still rather impressive) fur seals. The barking of the bulls was drowned out by the calls of thousands upon thousands of Kittiwakes and Guillemots on the cliffs behind the beach."



Kuril Islands:

"The sun strengthened and the winds died away, and we found

ourselves in genuine awe, none of us had seen seabird numbers like this anywhere else on earth. A handful of sea otters and sea eagles were sighted, and the volcano of Chirpoy island even belched off a little sulphur as a backdrop."

Kamchatka Peninsula:

"A brief cruise on the way back to the ship became somewhat lengthened when a grey whale was sighted. Incredibly rare in this part of the world, many of us stayed with the whale as it fed through the shallows at the back of the bay."

"Three orcas flowed along with us for a while, coming close to the bow, and no sooner had they moved on than Brent spotted a sperm whale. The captain slowed down and gently maneuvered the ship close, giving us spectacular views of this huge animal as he breathed for a while then fluked up for a deep dive."

"The river mouth was shallow and fast-flowing, and Sergey saw a bear near the huts when he went in to scout, so we stayed in the Zodiacs for a while to head upstream. After sighting a Steller's Sea Eagle and dozens of Red-throated divers, we rounded a bend and sure enough,

there was 'our' bear. For the next half hour or so, we stayed quiet and slowly edged the Zodiacs just a little further up the river until we were all against the bank watching this big bear, as he munched and snuffled in the vegetation."



Ariy Kamen and Nikolskoye, Bering Island, Commander Islands:

"When we arrived we found a tiny columnar basalt island absolutely covered in seabirds. Thousands of black-legged kittiwakes were joined by hundreds of their smaller, dainty red-legged relatives. Every ledge was packed, clusters of kittiwakes and clusters of common and Brunnich's guillemots, interspersed with glossy black red-faced and pelagic shags. A handful of horned puffins seemed to almost pose for us on some of the ledges, and higher up on the grass we could see auklets."



“

Few places in the world can offer experiences beyond one's imagination. But here, as we navigate along the Kamchatka Peninsula with its spectacular scenery, some of the richest wildlife in the world and skies dominated by vast colonies of seabirds, we can enjoy one of the last true wilderness areas.

”



Explorer Lounge



The Restaurant



Dining outside, Kamchatka

SILVER DISCOVERER

Formerly known as the MS Clipper Odyssey, the 120-passenger Silver Discoverer began her new life with Silversea Cruises in March 2014. Having been associated with the vessel for over ten years and with experience of operating voyages aboard her in the Russian Far East, we know her to be the perfect size and style vessel for expedition cruising in the region and are delighted to have chartered her for this voyage. The vessel's shallow draft will allow us to navigate in areas which larger ships would not be able to access and with the fleet of 12 onboard Zodiacs and expert expedition team we will be able to land on isolated shores. Whilst cruising, the vessel benefits from spacious deck areas from where you can watch for passing wildlife such as a breaching whale. The atmosphere onboard is relaxed and informal with the focus on the wonders of the destination you are visiting, which combined with the luxury surroundings, excellent service, superb cuisine and expert expedition team make for an expedition of a lifetime.

Your Suite

Accommodation onboard is arranged over four decks. Each suite affords considerable comfort with en-suite bathroom and outside views. Suites are spacious ranging in size from the View Suites at 181 square feet to the Medallion Suite which measures 408 square feet. All suites feature butler service and your suite's refrigerator and bar are stocked with your preferred beverages including wines and spirits. Your butler will replenish them upon request. Amenities in the suites include luxury Pratesi bed linen and bath amenities, ipod docking station, flat screen television with on-demand movies, music and satellite news programming, plush robe and slippers, hairdryer and WiFi internet access (charges apply). The beds in each suite offer exceptionally comfortable mattresses and can be configured as double or twin.



Explorer Suite



Sun Deck



Discoverer Lounge



View Suite

Your Space

The spacious public areas onboard include the open seating restaurant and the Main Lounge where daily briefings, lectures and recaps from your expedition team will take place using the highest standard of presentation equipments including the multiple screens. For your convenience it is also possible to follow the onboard lectures from the comfort of your cabin. In addition to the Main Lounge there is the Discoverer Lounge, a relaxing and inviting space with a 24-hour tea and coffee station, comfortable seating and a well stocked travel library with reference books pertaining to the destinations we will be visiting. The Discoverer Lounge is the perfect venue to relax with a good book, recount your experiences with fellow travellers or to simply enjoy a pre-dinner drink watching the ever-changing scenery through the picture windows. Other facilities include a pool on Deck 5 with outside seating area, bar and Grill, a beauty and massage centre, sun deck and fitness centre.

Your Dining

Silver Discoverer offers four all-inclusive dining options. Select wines, premium spirits and speciality coffees, as well as juices and soft drinks are complimentary in all bars and lounges. No matter what dining option you choose you will savour fine cuisine with menus inspired by Relais & Chateaux, Silversea's preferred culinary partner. The Restaurant serves contemporary, international cuisine with menus featuring local specialities. The Restaurant is elegant yet casual with no formal evenings and no assigned times or tables allowing you the freedom to dine with whom and when you please. In addition there is the convenience of the poolside Grill for breakfast, lunch and dinner. For lunch you may prefer fresh pizza from the oven pizza or lighter fare and in the evening, fresh seafood and prime cuts are grilled tableside at The Grill on a heated volcanic rock plate. Alternatively you can enjoy a light breakfast or lunch in the casual atmosphere of the Discoverer Lounge or choose to have breakfast delivered to your suite or a formal dinner ordered from The Restaurant menu. Lighter fare is always available from the room service menu from 6am to 11pm.

ALL INCLUSIVE POLICY

All this included in the price of your expedition voyage aboard the Silver Discoverer.

- Economy class return scheduled air travel from London
- Overnight hotel accommodation in Tokyo with breakfast and welcome dinner
- 17 nights aboard the Silver Discoverer on full board basis with cuisine inspired by Relais & Chateaux
- Complimentary Champagne, wines and spirits throughout the vessel
- In-room bar setup and refrigerator stocked to your preference
- Room Service 06.00 to 23.00
- Onboard gratuities
- Shore Excursions
- Butler service for all suites and staterooms
- Complimentary parka jacket; backpack & water bottle
- Expert Expedition Team
- Overnight hotel accommodation in Seattle on breakfast only basis
- Transfers
- Port & Airport taxes

DECK 7

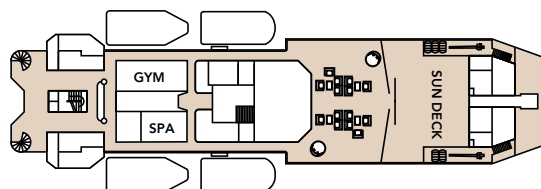

- MEDALLION SUITE
- VERANDA SUITE
- VISTA SUITE
- VIEW SUITE
- EXPLORER SUITE

DECK 6

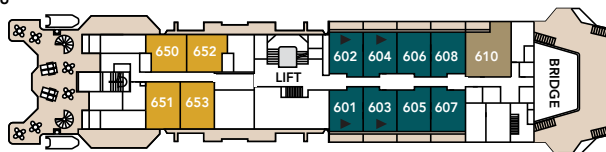

DECK 5

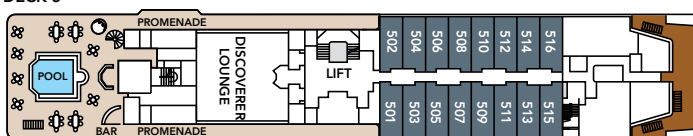

DECK 4

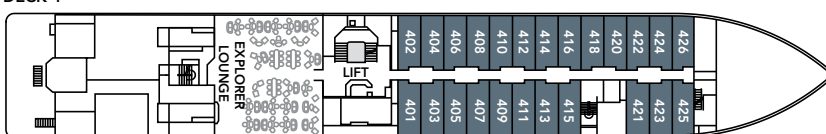

DECK 3

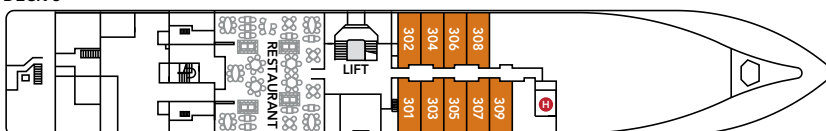

Bear and cubs



Humpback whale , Kuril Islands

THE ITINERARY

Day 1 London to Tokyo, Japan. Fly by scheduled flight.

Day 2 Tokyo. Arrive and transfer to the Shangri-La Hotel (or similar) for an overnight stay.

Day 3 Tokyo to Hakodate. Enjoy a morning tour before transferring to the airport for the scheduled flight to Hakodate. On arrival, transfer to the Silver Discoverer and meet your expedition team. This evening we set sail and our expedition begins.

Day 4 Cruising the Sea of Japan. During our first day at sea you will have an opportunity to attend one of several lectures about the cultural and natural history of the Russian Far East. Learn more about the wildlife we expect to see and the different cultures we intend to meet on our voyage.

Day 5 Korsakov, Russia. This port once served as a penal colony and achieved literary fame after a travel report by Anton Chekhov. We will have the opportunity to visit the city during a morning excursion which will include a cultural performance. See Yuzhno-Sakhalinsk's beautiful Cathedral of the Resurrection. The church was only completed in 1995 and the gold on the onion domes has very recently been laid, shining brilliantly. From the church continue to the Sakhalin Regional Museum, which is housed in a beautiful Japanese-style structure, due to the previous ruling of its southern neighbour. The museum covers all the facets of Sakhalin Island, from its flora and fauna, to its geology and history.

Day 6 Tyuleniy Island. Tyuleniy means "seal" in Russian, and during the summer months the island is home to literally tens of thousands of northern fur seals and Steller

sea lions. Our visit, at the height of the breeding season is well timed to see not only the seals and sea lions, but also tens of thousands of Common Guillemots and Black-legged Kittiwakes that have made their nests in the cliffs above.

Day 7 Chirpoy Island, Kuril Islands. Chyornie Bratya is the name for a pair of uninhabited volcanic islands between Simushir and Urup in the Kuril Islands chain in the Sea of Okhotsk in the northwest Pacific Ocean. The larger of the two is named Chirpoy. The origin of the names is uncertain: the original Ainu language name of the island was Repunmoshiri, a word meaning "place of many small birds". During a Zodiac cruise we search along the coast for the profusion of wildlife that lives in the area including Steller sea lions fulmars, kittiwakes, puffins and auklets. The layers of volcanic soil and stone are apparent in the cliffs at the water's edge. Much of the rocky shore is vibrantly coloured with iron-rich reds and almost blue-black basalts.



Zodiac cruising

Day 8 Yankicha Island and Matua Island. Yankitcka is impressive. Accessible only by Zodiac and only during high tide, it is actually a sinking volcanic caldera. Inside the magnificent lagoon with its fumaroles and hot springs, we can still see traces of the tremendous forces that created the island long ago and a visit here is invariably one of the highpoints of the voyage. The number of auklets, which breed

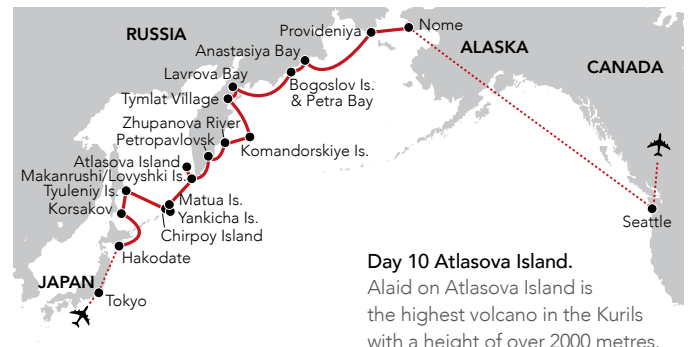

here, is truly incredible. During the afternoon we hope to land on Matua Island which is home to one of the Kuril's most active volcanoes, with more than 14 documented eruptions in the past 250 years.

We will learn about the Japanese military base that was set up here during WWII and how the Japanese used to capture geothermal heat from the volcano to keep the runway, which normally freezes over during winter, permanently usable. Hikers will be rewarded with good views of the abandoned military positions and will hopefully get a glimpse of the island's population of Brown-headed Thrush and Siberian Rubythroats in the alder thickets.

Day 9 Lovyushki Islands and Makanrushi Island. With our Zodiacs we will approach the clusters of rocks that comprise this island group - home to huge populations of sea mammals and birds. At Skaly Lovushky we will go in search of northern fur seals and steller seas lions and hope to get good views of the pigeon guillemots that often swim around the rocky outcrops of the islands. Makanrushi is an uninhabited volcanic island with an area of 49 square kilometres. The island is a dormant or extinct stratovolcano, Pik Mitaka, which rises to 1,169 metres above sea level. We will either explore by ship or by Zodiac.

Day 10 Atlasova Island.

Alaid on Atlasova Island is the highest volcano in the Kurils with a height of over 2000 metres. Together with our expedition staff we will land by Zodiac on the black lava beach of the island, from where we will begin our walk to see the remains of the Taketomi tufa cone.

Day 11 Petropavlovsk-Kamchatskiy, Petropavlovsk. town of Peter and Paul, derives its name from the two sailing ships used by Vitus Bering when the great explorer reached Avacha Bay in 1740. It is the only major city on the peninsula and one of the oldest towns in the Russian Far East. It is also the scientific and cultural centre of the region, and today we see just why that is, as our local guides take us on a comprehensive tour of the city's highlights. We will visit the museum of ethnography and natural history, the art school, the gold-domed Orthodox cathedral and the marketplace. We will have almost the entire day to explore the town. As an exciting alternative, it may be possible to purchase an optional helicopter excursion to the Valley of the Geysers in the Kronotsky Nature Reserve.

Day 12 Zhupanova River, Kamchatka Peninsula. By cruising the river with our highly manoeuvrable Zodiacs, we will have the ability to stop and go ashore wherever we expect to find the best birding and nature walks. Heading upstream, we are likely to spot up to 40 different bird species



Whiskered Auklet



Lake near Petra Bay



Tymlat Village, Kamchatka



Kuril Islands

and may even see brown bears fishing for salmon in the river.

Day 13 Nikolskoye, Komandorskiye Islands, Bering Sea.

The Komandorskiye or Commander Islands are named after famed Commander Vitus Bering who had been commissioned by the Russian Tsar to search for a land bridge between Asia and America. After having been to Alaska he was forced to overwinter here. He was buried on the island, but part of the crew managed to return to Petropavlovsk. Our experiences will be determined by weather, wildlife and sea conditions. We intend to visit Nikolskoye, which was established in 1826 by fur traders. This fishing village on Bering Island has a small museum where we will learn about the Aleut people and their culture. During our visit we will enjoy a concert and be entertained by a presentation of local games.

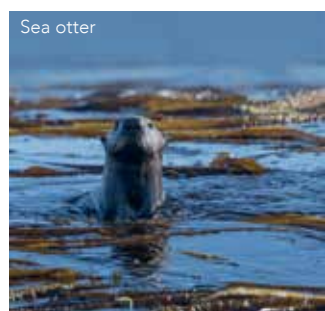

Sea otter

Day 14 Tymlat Village. Located in the Russian Far East on the Tymlat River that flows into the Bering Sea is Tymlat village. Arriving on Zodiac, we will be treated to some local hospitality and a sampling of their food, which includes salmon, navaga (a member of the cod family), herring, and caviar. The renowned cultural group "Mengo" may even treat us to a performance of folk songs and dance. You can

walk into the nearby village and see that many homes have little gardens or simple greenhouses to provide vegetables.

Day 15 Yushnaya Glubokaya and Lavrova Bay or Tintikun Lagoon.

During the early morning we will arrive at Yuzhnaya Glubokaya and will visit an abandoned fishing village that today is covered in wildflowers. This is an area well-liked by brown bears and activities will much depend on their presence. Depending on tidal conditions we will either enjoy a Zodiac cruise in Lavrova Bay or at Tintikun Lagoon. Lavrova Bay features a Russian shipwreck dating back to the 1970's and another abandoned fish camp. The mountains surrounding the lagoon are well liked by brown bears and we should be able to spot them grazing on the slopes.

Day 16 Petra Bay. Named after one of the ships used for the Bering expedition, Petra Bay is a sheltered bay and offers two hikes: one near the lighthouse close to the entrance of the bay with little climbing and only a short distance to cover; the other at the end of the bay, heading towards two lakes situated well above sea-level. While Larga Seals can be expected at the first landing, the other promises a longer hike and more birding.

Day 17 Anastasia Bay, Nataliya Bay and Bogoslov Island. In the afternoon we plan to cruise and explore this region by Zodiac, hoping to see a walrus haul-out. Birders will be on the lookout for White-fronted and Bean Geese and Whooper Swans. Depending on the conditions we might go ashore by Zodiac for nature walks amid a landscape surrounded by conical peaks and jagged cliffs, separated by valleys with lakes, waterfalls and tumbling streams.

Day 18 Cruising the Chukchi Sea.

Today is another opportunity to learn more about this remote part of the world and its inhabitants. Attend a lecture preparing you for Alaska and do not miss the DVD presented by our onboard videographer, highlighting all the different experiences and wildlife encounters we have had during the voyage.

Day 19 Provideniya, Russia (Cross the International Date Line and gain a day).

In Provideniya we will only stop for our outward clearance. While the Russian authorities make sure all formalities are completed, we will start our last day onboard with final lectures, summing up our unique expedition. Though today is technically considered Day 19 of our voyage, it is one very "short" day that includes approximately 19 hours of cruising the Bering Sea and crossing the International Date Line. We will actually arrive in Alaska before we left Provideniya –thanks to 24 hours gained crossing the International Dateline from west to east.

Day 20 Nome, Alaska, USA to Seattle. Disembark after breakfast and transfer to the airport for the scheduled flight to Seattle via Anchorage. On arrival, transfer to your hotel for an overnight stay.

Day 21 Seattle to London. Check out after breakfast and transfer to the airport for our scheduled flight to London.

Day 22 London. Arrive this morning.

Pre Cruise Tokyo extension



For those who would like to spend some more time in Tokyo we are offering a two night extension at the Shangri-La Hotel on a bed and breakfast basis including airport transfers and a full day tour to Nikko.

Prices per person based on double occupancy
Twin: **£745**; Single: **£995**

PRICES PER PERSON

Based on double occupancy

| LAUNCH OFFER – SAVE £500 PER PERSON ON A LIMITED NUMBER OF SUITES | | | |
|---|-----------------------------|----------------|--------------------|
| Cat | Cabin Description | Brochure Price | Launch Offer Price |
| 1 | Explorer Suite | £10995 | £10495 |
| 2 | View Suite | £11495 | £10995 |
| 3 | Vista Suite | £12495 | £11995 |
| 4 | Veranda Suite | £14195 | £13695 |
| 5 | Medallion Suite | £15195 | £14695 |
| 1 | Explorer Suite for sole use | £13495 | £12995 |
| 2 | View Suite for sole use | £14995 | £14495 |

Price Includes: Economy class scheduled air travel, overnight hotel accommodation in Tokyo with breakfast, 17 nights aboard the Silver Discoverer on a full board basis, all drinks whilst onboard, shore excursions, Expedition Team, transfers, all gratuities, overnight hotel accommodation in Seattle on a bed and breakfast basis, port taxes, airport taxes.

Not Included: Travel Insurance, optional helicopter excursion, Russian visa.
NB. Ports and itinerary subject to change and wildlife viewings can not be guaranteed. All special offers are subject to availability.



During this voyage you will be visiting out of the way destinations and will be accompanied by an expedition team. Landings and excursions will be made by Zodiac landing craft. This cruise will appeal to the more adventurous and those who enjoy the natural world.

NOBLE CALEDONIA

2 Chester Close, Belgravia, London, SW1X 7BE

+44 (0)20 7752 0000 | info@noble-caledonia.co.uk | www.noble-caledonia.co.uk

Our current booking conditions apply to all reservations and are available on request.
Cover image: Kronotsky Volcano

