

SPECIAL
OFFER - SAVE
£500
PER PERSON

WILDLIFE & WONDERS OF THE INDIAN OCEAN

DISCOVER MADAGASCAR, THE OUTER SEYCHELLES
& TANZANIA ABOARD THE MS CALEDONIAN SKY
WITH REAR ADMIRAL JOHN LIPPIETT

26TH OCTOBER TO 10TH NOVEMBER 2020



NOBLE CALEDONIA



Black and white ruffed lemur



Waterfalls, Reunion

Join us aboard the MS Caledonian Sky for this island hopping expedition through the Indian Ocean which will appeal to those who enjoy the natural world and all its wonders, travelling aboard a small ship and staying clear of the well-beaten tourist tracks. The all-suite MS Caledonian Sky with her fleet of Zodiac landing craft is the perfect vessel for such an enterprise. Carrying just over 100 guests, she is a far cry from the latest breed of cruise ships and can visit small islands and backwaters that are denied to larger vessels. Your experience will be made all the more memorable by the expert crew and officers, who along with our expedition team of marine biologists, ornithologists and botanists have many years of experience in the Indian Ocean and will provide commentary on all we see.

Setting sail from Mauritius we will land on its nearest neighbour, Reunion, a little bit of France in the Indian Ocean and a truly stunning place. We will spend the day exploring its awesome and dramatic landscape before continuing to Madagascar where over a period of three days we will explore the incredible verdant and beautiful island and its unique flora and fauna.

Continuing to the Seychelles, for many the highlight of the voyage will be our time spent exploring the Aldabra Island Group, the breeding ground of the giant tortoise and in addition to seeing some of these endearing creatures we should also encounter dolphins and turtles as well as countless birds including the flightless rail, the last flightless bird in the Indian Ocean. To explore the abundant crystal clear waters of the vast lagoon and to set foot on atolls which have never been exploited by the hand of man is a rare experience. Our final days are spent in Tanzania exploring Kilwa Kisiwani, a site of exceptional historical interest and we have a full day to explore atmospheric Zanzibar.



Guest Speaker



Rear Admiral John Lippiett CB CBE DL

John Lippiett had a 36 year career in the Royal Navy, serving in a large number of ships from aircraft carriers to minesweepers and deployed to all of the world's operational theatres. He was second-in-command of the frigate HMS Ambuscade throughout the Falklands War, and his book "War and Peas; Intimate letters from the Falklands War" was broadcast on BBC's Today programme for the 25th anniversary. John commanded three ships, a Frigate Squadron, and then the School of Maritime Warfare. On promotion to Rear Admiral, he flew his Flag at sea as Flag Officer Sea Training before serving in Naples as Chief of Staff of the NATO maritime forces in the Mediterranean. His final posting was as the Commandant of the Joint Services Command and Staff College. John retired and for nearly 13 years was the Chief Executive of the Mary Rose Trust, during which time he led the project to build the award-winning new museum and ensure Henry VIII's flagship is conserved and displayed for future generations. John retired from the Mary Rose Trust in 2016 and spends much time back at sea as a speaker on maritime history - and this time with his wife Jenny. He much enjoys telling the stories both of exploration, often using old maps, and of naval ventures that have taken place on the world's oceans over the last two thousand years. During this voyage John plans to reveal the maritime history of the Indian Ocean with insight into the ancient Greek and Arabian trade routes, tales of European discovery, Royal Naval operations as well as tales of the mighty Chinese treasure fleets and how China is now influencing the economies of the region today.

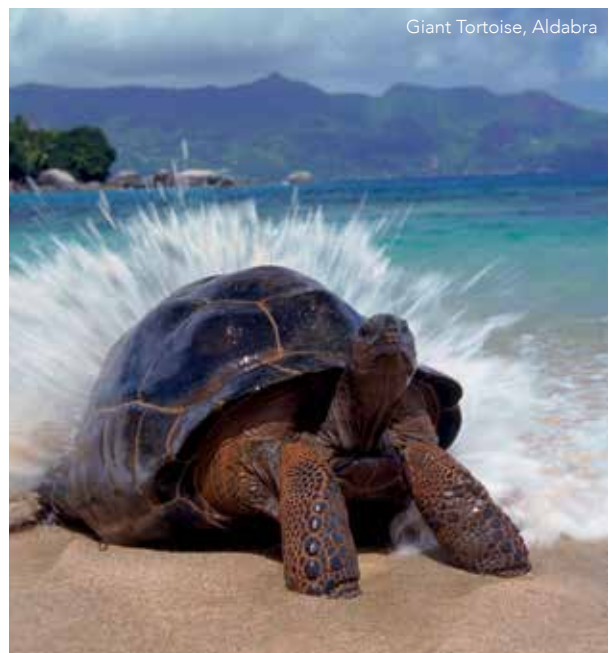

Giant Tortoise, Aldabra



The Itinerary

Day 1 London Gatwick to Mauritius. Fly by scheduled indirect flight.

Day 2 Mauritius. Arrive this afternoon and transfer to our hotel (Trou aux Biches Beachcomber or similar) for an overnight stay. The rest of the day is free to enjoy the hotel facilities before we meet for dinner in the hotel this evening.

Day 3 Mauritius. Enjoy breakfast in the hotel. After checking out our island tour will include the Trou-aux-Cerfs Volcano, the Grand Bassin Lake and Black River Gorges before transferring to the MS Caledonian Sky in the late afternoon. Enjoy welcome drinks and dinner as we sail tonight.

Day 4 Reunion. We arrive at breakfast in Port Est, Reunion where we have a choice of excursions. On a full day tour we will visit the central highlands where spectacularly rugged peaks of dormant or extinct volcanoes cradle huge amphitheatres known as cirques, where mountains tower to over 10,000 feet and beautiful waterfalls plummet hundreds of feet. We will enjoy views from the Nez des Bouefs and see the Piton de la Fournaise crater. After enjoying a Creole lunch in a local restaurant, we will visit the "Cite du Volcan" museum. Alternatively enjoy a morning tour to a vanilla plantation in St Andre where we learn about the history and culture of this integral part of Reunion's heritage. We will also enjoy some free time in St Denis before returning to the MS Caledonian Sky for lunch and enjoy an afternoon at leisure before we set sail this evening.

Day 5 At Sea. Spend the day at sea. Maybe join a lecture in the lounge, enjoy a book in the library or spend time on deck as we cross to Madagascar.

Days 6 & 7 Nosy Mangabe & Masoala National Park, Madagascar. Spend a day and a half in Antongil Bay area. We discover Nosy Mangabe, a 520-hectare island reserve and one of the most diverse areas of virgin rain forest in Madagascar which has also been an important research centre since the mid-1960s when several aye-ayes and lemurs were released into the forest. We will use our Zodiacs to land on the beach next to the forest and organise a series of nature walks looking at the varied trees, plants and ferns and we hope to spot chameleon, lizards and black and white ruffed lemur. For the birders, we will keep an eye out for Madagascar buzzard, kingfisher and paradise flycatchers. We also explore Madagascar's largest protected area, the Masoala National Park, which comprises of coastal rainforest, flooded forests, marsh and mangroves. Mammal species encountered include the red-ruffed lemur, the red-fronted brown lemur and the ring-tailed mongoose. The park is also home to various species of brightly coloured mantella frogs, all manner of extraordinary chameleons and is a refuge of the endangered Madagascar red-owl, Madagascar serpent eagle and many endemic bird species. A series of walks for all levels will operate whilst there will also be the option to swim off the beach or perhaps visit the local village.

Day 8 Diego Suarez. Over lunch, we will enter dramatic Diego Suarez, a stunning natural harbour with a cosmopolitan mix of inhabitants including Creoles, Indians, Chinese, Comorans and Arabs. This afternoon choose from a city tour visiting the Commonwealth Cemetery and Place Joffre, or the Malagasy Rain Forest at the Mount Amber National Park. Dividing into short and long walk parties we will go in search of lemurs and chameleons as we explore the rain forest. In the towering vegetation, we may spot several species of lemurs and chameleons as well as endemic birds, including parrots.

Days 9 to 11 Aldabra Island Group, Seychelles. Spend a relaxing morning at sea before arriving at the Aldabra group of islands where we have two and a half days to explore. Our itinerary will be in the hands of our Expedition Leader and Captain who will monitor the local conditions to ensure we maximise our time here. Whilst our itinerary is flexible, we hope to call at the island of Assumption which was ruthlessly plundered for its vast deposits of guano in the early 20th century. Happily, peace has returned, and the wildlife of rare birds and green turtles are once again in abundance. Our time here will be spent beachcombing, on a nature walk or snorkelling. We also hope to reach Cosmoledo where a huge ring of twelve islands circle a lagoon. Many of the atolls are still to be surveyed and we will explore some of them by Zodiac. This is an Important Bird and Biodiversity Area with all three species of booby found in the Seychelles

including the last breeding site for the brown booby. Also spot sooty terns and great frigate birds. We will also spend time on Aldabra, the island referred to by Sir Julian Huxley as "One of nature's treasures and should belong to the whole world". Aldabra is unique and every time we call at what is believed to be the world's largest atoll we find something new of interest. Sightings have been made of the extremely rare white throated rail and the atoll is also home to the world's second largest colony of frigate birds and to the largest crab, the coconut crab. Whilst exploring by Zodiac it is difficult to know in which direction to look. The clear blue seas abound with life, the skies are alive with varied birdlife and ashore giant land tortoises forage as they have done for millions of years. We hope to explore Picard Island with a short walk to see some of the thousands of tortoises and numerous robber crabs or swim in the lagoon, a vast 17 mile stretch of shallow clear water. From our Zodiacs we can watch the ever-changing undersea world and snorkel in colourful coral waters.

Day 12 At Sea. Spend a relaxing day at sea.

Day 13 Kilwa Kisiwani, Tanzania. This morning we anchor off Kilwa Kisiwani, a site of exceptional historical interest, where the atmospheric ruins represent a wide sweep of East African coastal history, from the heights of the Swahili and Shirazi trading civilisation to the darker days of slavery and the uprisings against German rule. Once one of Africa's



Masoala National Park

wealthiest towns, Kilwa Kisiwani is now a UNESCO World Heritage Site and contains the world's most extensive and best-preserved Swahili ruins. We will spend the afternoon on a walking tour and see the prominent fort and the Great Mosque which stood at the heart of this ancient city which was once the largest in East Africa. This afternoon we continue our cruise across the Indian Ocean.

Day 14 Zanzibar. Here the colourful harbour, crowded with dhows, very much sets the scene for our visit to this Arab-style city with its long narrow streets, bazaars, houses with overhanging balconies and intricately carved doorways. On a morning walking tour, soak up the timeless

atmosphere of Stone Town including Livingstone House, Sultan's Palace, the slave market and the Old Fort. The afternoon is free to relax and explore independently or join a tour to a spice farm to experience the various fruits and spices cultivated on the island. Alternatively, travel to Jozani Forest which sustains a variety of wildlife and birds, including the rare red colobus monkey, indigenous to the island.

Day 15 Dar Es Salaam to London Heathrow. Disembark after breakfast and transfer to the airport for our scheduled indirect flight to London.

Day 16 London Heathrow. Arrive this morning.

PRICES PER PERSON

Based on double occupancy

SPECIAL OFFER – SAVE £500 PER PERSON FOR A LIMITED TIME ONLY

Deck	Suite Category	Brochure Price	Special Offer Price
Castle	Standard	£9495	£8995
Caledonian	Superior	£9795	£9295
Promenade	Premium	£9995	£9495
Bridge	Deluxe Balcony	£10995	£10495
Promenade	Premium Balcony	£11295	£10795
Promenade	Owners Corner Suite with balcony	£12495	£11995
Castle	Standard for sole use	£11495	£10995
Caledonian	Superior for sole use	£11795	£11295

PRICE INCLUDES: Economy class scheduled air travel • Overnight hotel accommodation in Mauritius on a half board basis • 12 nights aboard the MS Caledonian Sky on a full board basis • House wine, beer & soft drinks with lunch & dinner on board • Noble Caledonia expedition team • Shore excursions • Gratuities • Transfers • Port taxes.

Not Included: Travel insurance, visas.

Post-Cruise Selous Safari Extension 9th to 13th November 2020

Giraffe, Selous Game Reserve



Before returning home, we are offering an extension to the Selous Game Reserve which is home to over 1,000,000 large animals and over half of Tanzania's elephant population. However, one of the major attractions must be the mighty Rufiji river, home to one of the largest crocodile and hippo populations in Africa, swarming with fish which in turn bring about some of the world's best water birding. The river has also formed several large lakes on its northern bank, navigable by boat and Siwandu Camp is situated on one of these lakes. All safari tents at the camp are widely spaced along the lake shore ensuring maximum privacy and wonderful views. Each tent sits atop its own raised timber platform with two large verandas. The spacious tents are luxuriously appointed, with en-suite bathrooms and open air hot-water showers. The camp has its own swimming pool, enabling guests to cool off in the heat of the day. The dining area and bar areas are raised on viewing platforms, with large comfortable sofas and a wildlife reference library.

The Itinerary

Day 1 Dar es Salaam to Selous, Tanzania. After breakfast we will disembark and transfer to the airport for our 45-minute scheduled flight to Mtemere Airstrip in the Selous Game Reserve. On arrival transfer to the Siwandu Camp and this afternoon enjoy your first game experience with a boat safari looking for hippos, crocodiles and birdlife.

Days 2 & 3 Siwandu Camp, Selous Game Reserve. Enjoy two full days in the Reserve with included game drives each day. Maybe enjoy a full day game viewing with a picnic lunch or a half day walking safari through the bush with a ranger. Alternatively join another boat safari or simply relax in your tent.

Day 4 Selous Game Reserve to Dar es Salaam to London. Enjoy breakfast in the hotel and a final safari option before transferring to the airstrip for your flight to Dar es Salaam where we connect with our onward scheduled flight to London.

Day 5 London. Arrive this morning.

PRICES PER PERSON

Based on double occupancy

Twin: **£3295** Single: **£4295**

Price Includes: Internal flights between Dar es Salaam and Selous Game Reserve, three nights accommodation at the Siwandu Camp on a full board basis, game drives, transfers, gratuities, storage of main cruise luggage at hotel in Dar es Salaam, taxes. **Not Included:** Travel insurance, Tanzania visa.

MS CALEDONIAN SKY



Deluxe Balcony Suite



On Deck



The Restaurant

The MS Caledonian Sky is one of our three flag ships and sister vessel to the MS Island Sky and MS Hebridean Sky. All three vessels were built in the same ship yard in Italy at similar times and share the same excellent attributes that make them three of the finest small ships in the world. With a maximum passenger capacity of only 114, a vessel of her size is capable of carrying many more but instead the MS Caledonian Sky has the benefit of unusually large suites, luxuriously appointed public areas and spacious outside decks.



Your Suite

On board there are 57 exceptionally spacious and well designed suites. The passenger accommodation is arranged over four decks and all suites have outside views. All feature a sitting area and some have private balconies. Each affords considerable comfort with en-suite bathroom featuring a country style wash basin, heated towel rail, vanity unit and walk-in shower and/or bath tub. Facilities in the suites also include walk-in or spacious wardrobes, dressing table

with large mirror and stool or desk, mini-fridge, flat screen television, telephone, programmable electronic safe, hairdryer, assorted Molton Brown toiletries, air-conditioning and heating. Refillable water bottles, dressing gowns and slippers are also provided for your comfort.

Your Dining

With only one sitting and a maximum of just over 100 passengers, the cuisine on board the MS Caledonian Sky is of a consistent superior quality that befits such a vessel. In keeping with the informal atmosphere on board, when dining you are able to choose your seating arrangements and choice of restaurants at your leisure; whether that be joining a table of four to six other passengers in the elegant à la carte Restaurant or outside buffet-style on the Lido Deck in the evening sunshine. In the main Restaurant, breakfast is served buffet-style, with certain items cooked to order on request. Lunch and dinner menus offer plenty of choice, often reflecting the daily catch and local delicacies. The Welcome and Farewell dinners are a sumptuous five course affair. To enhance your dining experience further a selection of wines is included with both meals. Afternoon tea and pre-dinner canapés take place in either the comfort of the Lounge or out on the Lido Deck when the weather is favourable. Tea and coffee are also available 24 hours a day. Special diets can be catered for with sufficient notice.



Standard Suite



Caledonian Lounge



The Library

Your Space

The spacious and finely decorated public rooms include a large lounge where briefings are given by the onboard team and talks from Guest Speakers take place. Also in the Lounge is a 24-hour tea and coffee station along with an elegant bar where the onboard pianist plays periodically throughout the day. In addition there is the Lounge on the Panorama Deck which has a bar, library and further spacious seating arrangements, ideal for watching the world go by as you cruise to your next destination. The Travel Library is the perfect place to relax with a good book and is well stocked with reference books pertaining to the destinations the vessel is visiting. A selection of games and devices to access the internet via the ship's satellite can also be found in the library. Access to the ship's satellite Wi-Fi via your own device is complimentary on board (signal strength varies depending on location and demand). Outside there is a rear Lido Deck where meals are served in warm weather under shade. On the top deck there is a further observation and Sun Deck with bar service and comfortable deck furniture for sun bathing or relaxing with a book. There is also a small beauty salon with appointments made on request.

Your Comfort

The MS Caledonian Sky is equipped with the latest safety, navigation and communications equipment along with roll stabilisers to minimise the ship's motion. During your voyage we hope to offer you the opportunity to visit the Captain and Officers on the Bridge to check the vessel's progress by charts and learn more about your journey. On board you will also find a clinic and Doctor and a lift that serves all decks. When at anchor our nimble Zodiacs will ferry you ashore or, on select cruises, enjoy Zodiac cruises getting you closer to the natural world.

Your Life On Board

The atmosphere on board is warm and convivial and more akin to a private yacht or country hotel in which you can learn more about the wonderful destinations you are visiting in the company of like-minded people. Dress on board is casual and relaxed and there will be no "black tie" evenings. On board there is a high ratio of crew to passengers. Our friendly crew of 75 are mainly Filipino and Eastern European and our Scandinavian Captains are experienced mariners. After a day ashore you will return to the comfort and peace of a well-run and exceedingly comfortable ship where peace, high quality of service and attention to detail are the order of the day. A little music in the Lounge after dinner, Guest Speakers and informative port briefings from our Expedition Leader or Cruise Director and of course good food, all contribute to make any voyage aboard this wonderful vessel a memorable and joyful experience.

MS CALEDONIAN SKY DECK PLAN

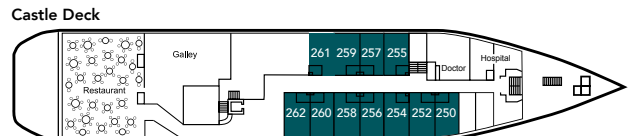
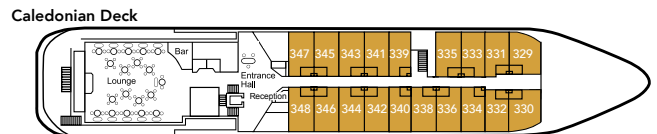
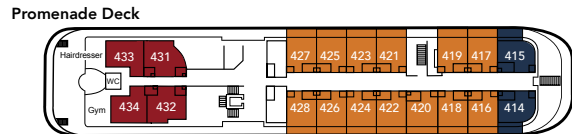
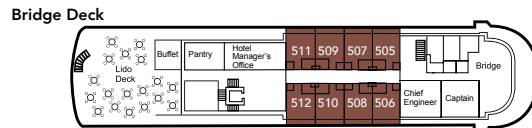
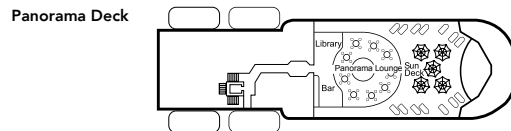
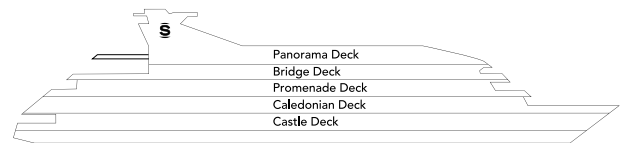

- Standard Suites
- Premium Suites
- Premium Balcony Suites
- Superior Suites
- Deluxe Balcony Suites
- Owner's Corner Suites with Balcony

Please note that all suites on Castle Deck feature a minimum of two portholes.

During this voyage you will be visiting out of the way destinations and will be accompanied by an expedition team. Landings and excursions will be made by Zodiac landing craft. This cruise will appeal to the more adventurous and those who enjoy the natural world.



NOBLE CALEDONIA

2 Chester Close, Belgravia, London, SW1X 7BE
 +44 (0)20 7752 0000 | info@noble-caledonia.co.uk | noble-caledonia.co.uk

