

NOBLE CALEDONIA

SPECIAL
OFFER - SAVE
£400
PER PERSON

PASSAGE TO ICELAND

AN EXPLORATION FROM SCOTLAND TO
ICELAND INCLUDING THE FAROES
ABOARD THE MS CALEDONIAN SKY

1ST TO 13TH JUNE 2021



Join us aboard the MS Caledonian Sky for an expedition which combines an in-depth exploration of the remote and little visited Faroe Islands with time spent exploring Iceland, one of the most extraordinary and dramatic lands on the planet. A journey by small ship is the ideal way to get up close to nature and explore areas inaccessible to larger vessels and an expedition such as this can only be undertaken by a special vessel with the self-sufficient qualities of the MS Caledonian Sky. With her expert team and fleet of Zodiacs we will be able to land on remote beaches and cruise close to shorelines and cliffs crowded with birdlife. With just over 100 travelling companions, the atmosphere on board is warm and friendly and ashore with our local experts we will divide into small groups thereby enjoying a more comprehensive and peaceful experience.

We will set sail from Oban, enjoying the opportunity to visit St Kilda before sailing north to the Faroe Islands. Once a stopping point for Viking explorers, this mysterious collection of 18 islands set in the North Atlantic, halfway between Norway and Iceland, is a paradise for walkers and bird watchers. The intriguing history of the islands can be traced back to the Irish monks who settled here in the 6th century and the 9th century seafaring explorers who traversed the North Sea. Here, a highlight will be seeing the many puffins and other sea birds nesting and we will spend three days exploring the villages and rolling hills of these distant isles before venturing further north to Iceland.

Iceland is without doubt one of the most extraordinary and dramatic lands on the planet and whilst exploring the island we will witness the immense scale of the landscape dominated by towering snow-capped mountains, thundering waterfalls and spontaneous erupting geysers as we learn of the centuries old legacies of a Viking and Norse heritage. Europe's least populated country offers the visitor a truly unparalleled experience of elemental forces at work. We will visit some of its most dramatic areas and, whilst we sail its waters, will look out for humpback whales, orcas, white-beaked dolphins and observe the colonies of seabirds.

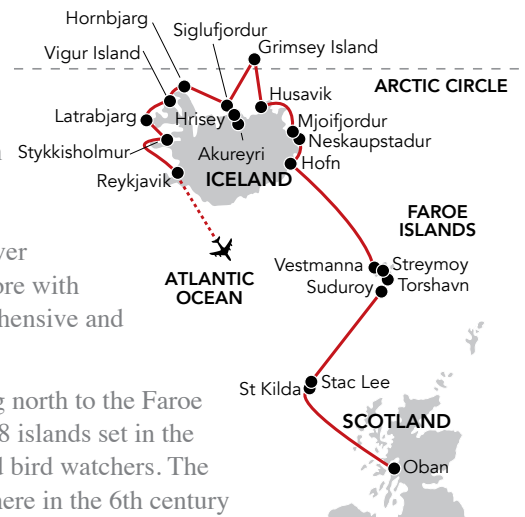

The Itinerary

Day 1 Oban, Scotland. Embark the MS Caledonian Sky this afternoon. Transfers will be provided from Glasgow Airport and Glasgow Central Station at a fixed time. Sail early this evening.

Day 2 St Kilda & Stac Lee. Awake this morning in St Kilda, a remarkable uninhabited archipelago some fifty miles beyond the Outer Hebrides. Dominated by the highest cliffs and sea stacks in Britain, Hirta, St Kilda's main island was occupied on and

off for at least two thousand years, with the last 36 Gaelic speaking inhabitants evacuated at their own request in 1930. Immediately after the evacuation, the island was bought by the Marquess of Bute to protect the island's thousands of seabirds including puffin and fulmars, and in 1957 it was bequeathed to The National Trust for Scotland. St Kilda is one of only two dozen UNESCO World Heritage Sites with dual status reflecting its natural and cultural significance. The local ranger

will join us on board before our expedition staff lead a number of guided walks on the island. Later, cruise past one of the largest gannetries in the world, Stac Lee.

Day 3 Suduroy, Faroe Islands. Over lunch we will arrive at Suduroy, the southernmost island of the Faroe Islands. From the port of Tvøroyri we will have a choice of activities. Choose to join an island drive passing the beautiful scenery as we drive between the villages seeing the stunning geology, fjords, tunnels

and architecture of the island and end at the southernmost point and the Akraberg lighthouse. In Porkeri we will take the ridge-top road which winds up the mountainside for wonderful views towards the steep cliffs on the west coast, the Beinissvoro promontory to the north and the luscious grass slopes to the east. To locals, this delivers the essence of the Faroe Islands with mountains and fjords, villages and valleys, birds, sheep and nature. Alternatively, those feeling active may wish to join a hike to Hvaanhagi,



a beautiful, uninhibited place north of Tvoroyri on the east coast of Suduroy. The view is fantastic towards the three islands Litla Dimun, Stora Dimun and Skuvoy.

Day 4 Torshavn. From our berth this morning we will join a guided tour through Torshavn over the hills to Kirkjubour, the island's oldest cultural centre, where we see the ruins of the 13th century St Magnus Cathedral and the 11th century church, still in use. We also visit the 900-year old 'Roykstovan', the old bishopric, considered to be the oldest wooden house in Europe. For those feeling active we will arrange a hike in the hills surrounding the town to discover the local flora and fauna. After lunch on board, we will drive to the beautiful village of Saksun, an isolated settlement situated beneath steep majestic mountains. We visit Duvugaroar, an old farmhouse, which is now a museum and visit a traditional Faeroese wooden church in Kollafjord.

Day 5 Vestmanna. Vestmanna is our base this morning as we explore the northwest corner of Streymoy and the nearby cliffs. We will board local boats to explore the vertical cliffs that climb almost 1500 feet, sailing into grottos carved by the surf over the years and watching the thousands of seabirds including puffins, guillemots, fulmars and kittiwakes that nest here each summer. Return to the ship for lunch and spend a relaxing afternoon on board sailing towards Iceland.

Day 6 Hofn, Iceland. Today we will see the shimmering white

Vatnajokull Glacier, Europe's largest glacier, sometimes called an icecap. The 600 metre thick ice surmounts active volcanoes, one of which erupted in 1996, creating a crater on the surface of the glacier, a most unusual phenomenon. We will drive to the otherworldly glacial lagoon of Jokulsarlon, a dramatic drive through some of the finest scenery that Iceland offers. Once we reach Jokulsarlon, the 100 metre deep glacial river lagoon which is full of large icebergs, carved from the glacier Breioamerkurjokull, we will embark on a cruise on the pristine water, sailing in between the blue, white and black ice.

Day 7 Neskaupstadur & Mjoifjordur. Enjoy the benefits of our small ship as we explore the lesser known fjords in the south east of Iceland. This morning we hope to land at the small town at Neskaupstadur for a chance to visit the excellent museum which features the local art gallery, Museum of Natural History and Maritime Museum. The more active can hike to the avalanche barriers behind the town, offering great views of the surrounding areas. This afternoon we cruise through Mjoifjordur where we can enjoy the wilderness of this remote area.

Day 8 Husavik. Over breakfast we arrive in Husavik, known as the whale capital of Iceland. There will be a choice of excursions to choose from. Using local boats explore Skjalfandi Bay looking for one of the 15 species of whales, the most popular being humpback, minke and blue whales, as well as white beaked dolphins and

many different kinds of birds. After lunch on board we have the afternoon to explore the pretty town including time at the excellent whale museum, the exploration museum and quaint local church. Alternatively, visit the Lake Myvatn-Krafla area, a fine example of the volcanic world with lava fields, boiling and steaming mud pools and steam vents of sulphur and craters. The area illustrates the sheer magnitude of Iceland's forces at work. The lake itself, with beautiful natural rock formations and hot springs, is also a unique ecosystem and the largest migratory bird sanctuary in Europe. We will offer time in the natural baths before returning to the ship.

Day 9 Grimsey Island & Siglufjordur. Spend the morning on Grimsey Island. The Arctic Circle bisects this island which is known for its tiny community, basalt cliffs and large variety of birdlife. On arrival join our expedition team members for a nature walk on the island. Over lunch we sail to Siglufjordur, a picturesque town that enjoys an idyllic setting in a small fjord backed by mountains. Here in the early 1900s, a booming economy due to the herring industry resulted in a prosperous town with some marvellous Icelandic architecture. Stroll through the town and visit the Herring Era Museum. Be on deck early this evening as we sail down Eyafjordur, on the lookout for whales, during our approach to Akureyri.

Day 10 Akureyri & Hrisey Island. Akureyri is a delightful town on the north coast of Iceland and

not what you would expect to find in such a remote location. In summer months the gardens and window boxes are ablaze with colour. On a morning tour we visit the spectacular Godafoss Waterfall where water from the Skjalfandafjot river falls from a height of 12 metres over a width of 30 metres. From Godafoss we return to the charming town of Akureyri and visit the botanical garden which was founded in 1912 and grows examples of every species indigenous to Iceland as well as an extensive collection of high-latitude and high-altitude plants from around the world. Our tour ends at the Art Alley, where artisans keep their workshops and galleries. Return to the ship for lunch and sail to Hrisey Island this afternoon where you can join nature walks. The island is known for its rich and diverse bird life and approximately 40 species of bird's nest on the island.

Day 11 Hornbjarg & Vigur Island. In the early morning we will sail by the Hornbjarg Cliffs. These stunning cliffs rise 534 metres from the sea and are one of the largest centres for puffins in Iceland. We continue to the Western Fjords, an isolated but spectacular area of Iceland. Arriving in the early afternoon we will explore Isafjardardjup with the MS Caledonian Sky and depending on local weather conditions, we hope to land on Vigur, a serene little island with only five residents but home to many more puffins, eider ducks, black guillemots and Arctic terns. We will also visit Iceland's only extant windmill dating from the 19th century.



Day 12 Latrabjarg & Stykkisholmur. During breakfast we will cruise past the Latrabjarg cliffs, the westernmost point of Europe. Later on, we sail to Stykkisholmur located in Breidafjordur Bay and surrounded by an archipelago of islands. The town is famed for its beautiful and well preserved old houses and is also the gateway to the Snaefellsnes Peninsula which is dominated by the Snaefellsjokull volcano, regarded as one of the symbols of Iceland and known as the setting for Jules Verne's "Journey to the Centre of the Earth". Enjoy an afternoon tour which will include a drive through the lava landscape to the glacier visiting pretty fishing ports and beaches along the way or spend the afternoon at leisure in the town.

Day 13 Reykjavik to London. Disembark after breakfast and transfer to the airport for your scheduled flight to London.

SHIP TO SHORE

This voyage is a combination of both expedition style cruising and small ship destination cruising. Whilst we will be alongside most days, we will be at anchor and the vessel's Zodiacs will be utilised to transport passengers ashore when visiting St Kilda, Grimsey, Hrisey Island and Vigur Island. The use of the Zodiacs will be key to the operation of the planned itinerary. If you have any queries pertaining to the use of Zodiacs or the level of fitness required for this voyage please do not hesitate to ask one of our experienced travel consultants.

PRICES PER PERSON

Based on double occupancy

SPECIAL OFFER – SAVE £400 PER PERSON FOR A LIMITED TIME ONLY

Deck	Suite Category	Brochure Price	Special Offer Price
Castle	Standard	£7395	£6995
Caledonian	Superior	£7595	£7195
Promenade	Premium	£7795	£7395
Bridge	Deluxe Balcony	£8595	£8195
Promenade	Premium Balcony	£8795	£8395
Promenade	Owners Corner Suite with balcony	£9395	£8995
Castle	Standard for sole use	£10395	£9995
Caledonian	Superior for sole use	£10795	£10395

PRICE INCLUDES: Economy class scheduled air travel from Reykjavik to London • 12 nights aboard the MS Caledonian Sky on a full board basis • House wine, beer & soft drinks with lunch and dinner on board • Noble Caledonia onboard team • Shore excursions • Gratuities • Transfers • Port taxes.

Not Included: Travel insurance.

Post-cruise Reykjavik Extension 13th to 15th June 2021



If you would like to spend some time in Reykjavik after disembarking the MS Caledonian Sky, we are offering a two-night optional extension staying at a centrally located hotel on a bed and breakfast basis. During your stay there will be a half day Reykjavik city orientation tour and a full day tour to the Golden Circle including the Geysir geothermal area, Gullfoss Waterfall and Thingvellir National Park.

PRICES PER PERSON

Based on double occupancy

Twin: **£875** Single: **£1245**

Price Includes: Two nights hotel accommodation in Reykjavik with breakfast, full day Golden Circle tour, half day city tour, Tour Manager, gratuities, transfers.

Not Included: Travel insurance.

MS CALEDONIAN SKY



Deluxe Balcony Suite



On Deck



The Restaurant

The MS Caledonian Sky is one of our three flag ships and sister vessel to the MS Island Sky and MS Hebridean Sky. All three vessels were built in the same ship yard in Italy at similar times and share the same excellent attributes that make them three of the finest small ships in the world. With a maximum passenger capacity of only 114, a vessel of her size is capable of carrying many more but instead the MS Caledonian Sky has the benefit of unusually large suites, luxuriously appointed public areas and spacious outside decks.



Your Suite

On board there are 57 exceptionally spacious and well designed suites. The passenger accommodation is arranged over four decks and all suites have outside views. All feature a sitting area and some have private balconies. Each affords considerable comfort with en-suite bathroom featuring a country style wash basin, heated towel rail, vanity unit and walk-in shower and/or bath tub. Facilities in the suites also include walk-in or spacious wardrobes, dressing table

with large mirror and stool or desk, mini-fridge, flat screen television, telephone, programmable electronic safe, hairdryer, assorted Molton Brown toiletries, air-conditioning and heating. Refillable water bottles, dressing gowns and slippers are also provided for your comfort.

Your Dining

With only one sitting and a maximum of just over 100 passengers, the cuisine on board the MS Caledonian Sky is of a consistent superior quality that befits such a vessel. In keeping with the informal atmosphere on board, when dining you are able to choose your seating arrangements and choice of restaurants at your leisure; whether that be joining a table of four to six other passengers in the elegant à la carte Restaurant or outside buffet-style on the Lido Deck in the evening sunshine. In the main Restaurant, breakfast is served buffet-style, with certain items cooked to order on request. Lunch and dinner menus offer plenty of choice, often reflecting the daily catch and local delicacies. The Welcome and Farewell dinners are a sumptuous five course affair. To enhance your dining experience further a selection of wines is included with both meals. Afternoon tea and pre-dinner canapés take place in either the comfort of the Lounge or out on the Lido Deck when the weather is favourable. Tea and coffee are also available 24 hours a day. Special diets can be catered for with sufficient notice.



Standard Suite



Caledonian Lounge



The Library

Your Space

The spacious and finely decorated public rooms include a large lounge where briefings are given by the onboard team and talks from Guest Speakers take place. Also in the Lounge is a 24-hour tea and coffee station along with an elegant bar where the onboard pianist plays periodically throughout the day. In addition there is the Lounge on the Panorama Deck which has a bar, library and further spacious seating arrangements, ideal for watching the world go by as you cruise to your next destination. The Travel Library is the perfect place to relax with a good book and is well stocked with reference books pertaining to the destinations the vessel is visiting. A selection of games and devices to access the internet via the ship's satellite can also be found in the library. Access to the ship's satellite Wi-Fi via your own device is complimentary on board (signal strength varies depending on location and demand). Outside there is a rear Lido Deck where meals are served in warm weather under shade. On the top deck there is a further observation and Sun Deck with bar service and comfortable deck furniture for sun bathing or relaxing with a book. There is also a small beauty salon with appointments made on request.

Your Comfort

The MS Caledonian Sky is equipped with the latest safety, navigation and communications equipment along with roll stabilisers to minimise the ship's motion. During your voyage we hope to offer you the opportunity to visit the Captain and Officers on the Bridge to check the vessel's progress by charts and learn more about your journey. On board you will also find a clinic and Doctor and a lift that serves all decks. When at anchor our nimble Zodiacs will ferry you ashore or, on select cruises, enjoy Zodiac cruises getting you closer to the natural world.

Your Life On Board

The atmosphere on board is warm and convivial and more akin to a private yacht or country hotel in which you can learn more about the wonderful destinations you are visiting in the company of like-minded people. Dress on board is casual and relaxed and there will be no "black tie" evenings. On board there is a high ratio of crew to passengers. Our friendly crew of 75 are mainly Filipino and Eastern European and our Scandinavian Captains are experienced mariners. After a day ashore you will return to the comfort and peace of a well-run and exceedingly comfortable ship where peace, high quality of service and attention to detail are the order of the day. A little music in the Lounge after dinner, Guest Speakers and informative port briefings from our Expedition Leader or Cruise Director and of course good food, all contribute to make any voyage aboard this wonderful vessel a memorable and joyful experience.

MS CALEDONIAN SKY DECK PLAN

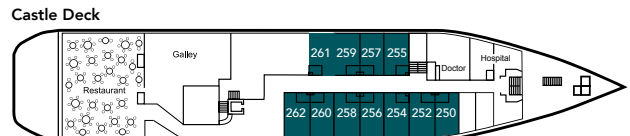
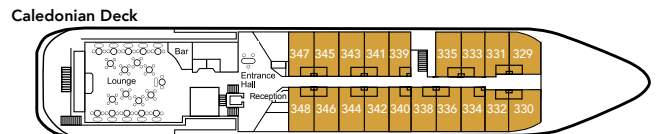
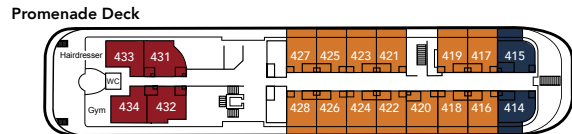
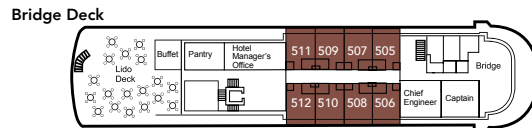
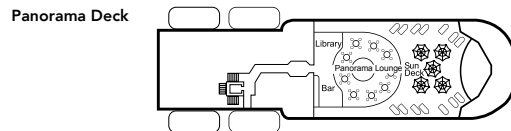
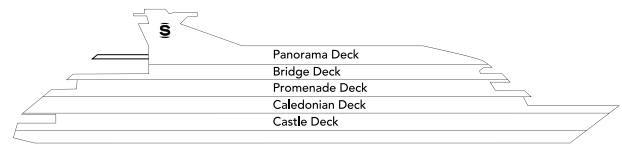

- Standard Suites
- Premium Suites
- Premium Balcony Suites
- Superior Suites
- Deluxe Balcony Suites
- Owner's Corner Suites with Balcony

Please note that all suites on Castle Deck feature a minimum of two portholes.



NOBLE CALEDONIA

2 Chester Close, Belgravia, London, SW1X 7BE
 +44 (0)20 7752 0000 | info@noble-caledonia.co.uk | noble-caledonia.co.uk



All special offers are subject to availability. Our current booking conditions apply to all reservations and are available on request.
 Cover image: Snaefellsnes Peninsula