

2025 DEPARTURE RELEASED DUE TO POPULAR DEMAND

SPECIAL
OFFER - SAVE
£500
PER PERSON

NATURAL WONDERS OF COSTA RICA

AN EXPLORATION BY LAND & SEA
ABOARD THE NATIONAL GEOGRAPHIC QUEST

7TH TO 19TH NOVEMBER 2024 & 14TH TO 26TH NOVEMBER 2025



NOBLE CALEDONIA



Costa Rica is a small country, yet its particular topography and position between the Atlantic and Pacific Oceans result in it being one of the most biologically diverse places on earth. It has, over recent years, grown in its appeal to the UK traveller. No wonder when you consider its attractions: bountiful rain forests, cloud forests, soaring volcanoes, sugar sand beaches and a remarkably diverse landscape and culture. Added to this is the famous wildlife of the region: spider, howler and capuchin monkeys, coatimundis and over 300 species of birds including brilliant toucans and scarlet macaws. We are therefore delighted to be offering this new, unique journey to Costa Rica which combines a six night escorted tour with a five night voyage aboard the 100-passenger National Geographic Quest, aboard which our associates at Lindblad Expeditions have provided us with an allocation of cabins.

Costa Rica offers some of the best tourism facilities with comfortable hotels, relatively good roads and excellent transportation and as we journey overland, we will discover a wealth of fascinating cultural and natural world marvels. After a night in San Jose, we journey to the Arenal Volcano region where we explore the forest, bathe in the nearby hot springs and hike to take in the volcano's natural beauty. Next we will explore Monteverde; famous for its lush rainforests and impressive assortment of flora and fauna, the area has a high biodiversity and we hope to spot many species of bird, butterfly, reptile, plant, tree and insect here as we explore with our guides.

Embarking the National Geographic Quest in Puerto Caldera, we set sail on a voyage to discover the treasures of one of Costa Rica's most intriguing provinces: Guanacaste. The Guanacaste Conservation Area is a UNESCO World Heritage Site and there will be opportunities to explore the magnificent underwater world and palm-lined beaches as well as to hike and learn about the hundreds of species of birds, reptiles and mammals that inhabit this thriving ecosystem. Other highlights include the mist-shrouded volcanic peaks in Rincon de la Vieja National Park and Curu Wildlife Refuge where we will explore in search of exotic wildlife, like macaws and white-faced capuchin monkeys moving from tree to tree. Your experience will be made all the more memorable by the onboard team of experts who will accompany you on the Zodiacs, hold daily lectures and briefings and lead guided nature walks ashore.





Exploring by Zodiac



Coati, Arenal National Park



Chestnut-mandibled Toucans

JOURNEY HIGHLIGHTS

- Explore the dense forest surrounding Arenal Volcano and relax in nearby hot springs.
- Hike through the mist-shrouded cloud forest reserve in Monteverde and enjoy great bird watching.
- Glide through a mangrove forest to see reddish egrets, spoonbills, white ibis, and crocodiles.
- Kayak, snorkel, swim, hike – actively explore every day.
- Explore Rincon de la Vieja National Park, which is alive with active volcanos and gurgling mud pots and replete with howler monkeys, waterfalls, and an optional zipline.
- Spend an afternoon enjoying Isla Tortuga's palm-shaded beaches before a barbecue dinner.

The Itinerary

Day 1 London to San Jose, Costa Rica. Fly by scheduled flight. On arrival transfer to the Real Intercontinental Hotel San Jose for our overnight stay. Meet your fellow travellers for dinner this evening.

Day 2 San Jose to Arenal. This morning after a leisurely breakfast, drive by coach to the lowlands and Arenal Volcano. En route we will visit the Poas Volcano National Park and enjoy a short walk before visiting a coffee plantation. On arrival at Arenal Kioro Suites & Spa Hotel, our base for the next three nights, weather permitting we will get our first glimpse of this magnificent and imposing volcano. Enjoy the rest of the afternoon at leisure before dinner is served in the hotel this evening.

Day 3 Arenal. Today there will be a morning tour of a local organic chocolate plantation. The rich volcanic soil of the Arenal area is perfect for growing cocoa. We will learn about the history of chocolate production in Costa Rica, see how it is made and of course try some of the local produce. In the afternoon enjoy a guided walk through the forests in the hope of seeing sloths. Dinner will be at the hotel this evening.

Day 4 Arenal. After breakfast we will head towards Arenal Volcano for a hike that will take in its natural beauty. We will explore the unique flora and fauna and there will be a stop at a viewpoint to see the ancient lava flows. Along the way our local guide will point out the wildlife that calls the vegetation home. After the hike we will transfer to a natural hot spring where there will

be time for a dip in the different temperature pools. Relax in the waters while taking in the sounds of the forests around you. After lunch at a local restaurant the rest of the afternoon will be at leisure to relax at the hotel. Dinner will be in the hotel this evening.

Day 5 Arenal to Monteverde. Today we will move away from the lowlands and its volcanoes to the beautiful cloud forests of Monteverde. Located over 1,200 metres above sea level, the Monteverde Cloud Forest Reserve offers a different natural environment to those seen so far on this tour. The dense forest is topped with low lying clouds and fog creating a great amount of moisture, and it is this moisture which helps promote a huge amount of biodiversity. The Monteverde National Reserve is home to over 100 species of mammals, 400 species of birds and 1,200 species of amphibians and reptiles. After lunch in a local restaurant, we will head out to explore the canopy of the forest. Taking the sky tram we will slowly start to rise through the trees to above the canopy into the forest clouds. From here we will be able to walk along the 2.5 kilometres of skywalk bridges that create a path through the treetops. Enjoy the spectacular views while keeping an eye out for local bird and wildlife. After descending, we head to the El Establo Mountain Hotel for our two night stay. Dinner will be in the hotel this evening.

Day 6 Monteverde. This morning we will explore the Monteverde National Reserve at ground level with guided walks. Take in the local flora and fauna and spot the wildlife above and at ground level. The afternoon will be at leisure and in the evening there will be the option to take part in a night walk in the National Reserve. Explore the trails with your guide seeing how the cloud forest changes at night.

Day 7 Monteverde to Puerto Caldera. After a leisurely breakfast we transfer to the coastal town of Puerto Caldera stopping for lunch en-route. Embark the National Geographic Quest this afternoon and enjoy dinner on board this evening.

Day 8 Zapotal Beach & Bahia Huevos. This morning, anchoring off the remote Zapotal Beach, we have the option to soak up the sun or snorkel in the waters fringed by offshore islets that have created an outstanding habitat and home for a variety of tropical fish. Alternatively join a walk with one of the onboard naturalists through the beautiful forests which are rich with bird and plant varieties. After lunch on board we continue sailing north to the Papagoya Peninsula, anchoring in Bahia Huevos. There will be the opportunity to explore the bay and peninsular by Zodiac as well as the nearby mangroves.



Day 9 Santa Rosa National Park & Guanacaste Conservation Area. Today, start the day with a snorkel or a hike into the upper reaches of the Guanacaste Conservation Area for spectacular views over the full length of this rarely visited archipelago. Back on board we will sail towards the mainland. Depending on conditions we will explore Santa Elena Bay in Santa Rosa National Park, Junquillal Wildlife Refuge or Cuajiniquil Bay. All are part of the extraordinary biodiversity of the Guanacaste Conservation Area. Whether venturing out by kayak or Zodiac immerse yourself in the tropical environment. Keep an eye on the tree line for yellow and black great kiskadees, orange fronted parakeets and mangrove hawks setting out for a late afternoon hunt.

Day 10 Rincon de la Vieja National Park & Hacienda Guachipelin. Today we will head inland and explore the Rincon de la Vieja National Park. This mountainous region that encompasses more than 34,000 acres is part of the Guanacaste Conservation Area. With forests carpeting the sides of two active volcanoes, this area is alive with geothermal activity. While in the National Park there will be the chance to hike and experience the transition zone where tropical dry habitat meets temperate cloud forest. Alternatively, there is the option of a shorter hike to the beautiful Las Chorreras waterfall.

Afterwards, enjoy a sumptuous lunch served poolside at Hacienda Guacipelin.

Day 11 Curu National Wildlife Refuge & Isla Tortuga. This morning we will explore the Curu National Wildlife Refuge, Costa Rica's first private national wildlife reserve. While exploring the park's many trails learn about the hundreds of species of birds, reptiles and mammals that inhabit this thriving ecosystem. Look out for white faced capuchin monkeys, turquoise-browed motmots and with any luck scarlet macaws. As we enjoy lunch on board, we cruise to a cluster of offshore islets, known as Isla Tortuga, where there will be time to relax on the beaches, kayak or paddleboard. As the sun starts to set enjoy a waterside barbeque dinner.

Day 12 Puerto Caldera to London. After breakfast disembark the National Geographic Quest in Puerto Caldera. Transfer back to San Jose for a city tour and lunch before heading to the airport for the overnight indirect scheduled flight to London.

Day 13 London. Arrive into London today.

PRICES PER PERSON
Based on double occupancy

SPECIAL OFFER – SAVE £500 PER PERSON FOR A LIMITED TIME ONLY					
Cat	Cabin Description	2024		2025	
		Brochure Price	Special Offer Price	Brochure Price	Special Offer Price
1	Main Deck with two portholes	£8495	£7995	£8795	£8295
2	Main Deck with two portholes	£8995	£8495	£9295	£8795
3	Upper Deck with large window	£9495	£8995	£9795	£9295
4	Upper Deck with sliding door & small balcony	£10295	£9795	£10595	£10095
5	Observation Deck Suite with large windows	£10495	£9995	£10795	£10295
1	Main Deck with two portholes for sole use	SOLD OUT	SOLD OUT	£11595	£11095
2	Main Deck with two portholes for sole use	SOLD OUT	SOLD OUT	£12095	£11595

PRICE INCLUDES: Economy class scheduled air travel • Six nights hotel accommodation in Costa Rica as described with breakfast • Lunch and dinner daily • Five nights aboard the National Geographic Quest on a full board basis • House wine, beer, spirits and soft drinks whilst on board • Onboard expedition team • Noble Caledonia Tour Manager • Shore excursions • Gratuities • Transfers • Port taxes.
Not Included: Travel insurance, premium drinks, Wi-Fi.



NATIONAL GEOGRAPHIC QUEST



Purpose-built to explore the North American coast, the National Geographic Quest accommodates just 100 guests in 50 outside cabins. The design and engineering of the National Geographic Quest were informed by nearly 40 years of experience of expedition cruising. Her twin boarding platforms, for example, enable the expedition team to load two Zodiacs at once, meaning guests can disembark the ship quickly to take advantage of wildlife sightings and maximise time spent exploring ashore. The vessel features a shallow draft, allowing the Captain to navigate the inner reaches and the onboard Zodiacs offer opportunities to get even closer to the action and land in remote locations. There are also kayaks, paddleboards and snorkelling equipment on board.



Category 4 Cabin



Dining Room



Lounge

Your Cabin

Cabins aboard the National Geographic Quest are an inviting place to end your day of activity. There are a total of 50 outside cabins on board and each one features either two portholes, large windows or step-out balcony. In each cabin, beds can be twin or converted to a Queen. Cabins range in size from 12.6 to 17.3 square metres and feature modern bathrooms, climate controls, hairdryer, Wi-Fi connections and USB ports for mobile devices. You will find organic botanical products in the bathroom.

Your Dining

Meals are served in the dining room at a single seating with unassigned tables, meaning you can dine with whomever you wish. The expedition team will dine alongside guests allowing for opportunities to discuss the highlights of the day and what is to come. The onboard chefs use fresh, local ingredients whenever possible, including locally grown produce, sustainably caught fish, and other local products. An array of fresh fruits and delicious fresh juices are key components of the breakfast buffet, as are fresh vegetables and fish at lunch and dinner. When conditions allow, lighter options may be served outside on the Observation Deck. A selection of drinks including beer and wine are served with lunch and dinner and there is a 24-hour self service beverage station available for tea, coffee and soft drinks.

Your Space

The spacious public areas include the main dining room and the comfortable lounge which features wrap-around windows for optimal views, a full-service bar and state-of-the-art presentation facilities. The lounge is where guests gather daily for talks and recaps. There is also a small reference library with board games. The vessel features a specially designed open bow and the outside deck has been designed as the perfect wildlife viewing platform which is in close proximity to the lounge allowing for instant access to spontaneous wildlife sightings. Outside there is also a partially covered and furnished sundeck with tables, chairs and lounge chairs for relaxing. To ease the embarkation and disembarkations for the daily activities, the vessel features a mudroom with lockers to store boots and other expedition gear. Another feature of the ship is the spa and fitness centre staffed by the wellness specialist. There is a shop on board stocked with local artisan products. Internet access, laundry service and a ship's doctor are available on board and there is a lift which serves all decks.

Life On Board

The atmosphere on board is relaxed and informal and focused on the marvellous scenery and wildlife we will be experiencing. Whilst sailing, you can relax on deck with a good book, spend time with the onboard specialists looking for wildlife, relax with a massage in the spa, take part in some morning stretches on deck with the wellness specialist or scan the horizon from the open Bridge with the binoculars provided on board. The vessel carries expedition equipment including eight Zodiac landing craft, kayaks, paddleboards, snorkelling gear and an underwater video camera. There is a high ratio of crew to passengers and after a day ashore you will return to the comfort and peace of an exceedingly comfortable ship.



Category 5 Cabin



Sundeck



Library



Category 1 & Category 2 Cabin

NATIONAL GEOGRAPHIC QUEST DECK PLAN

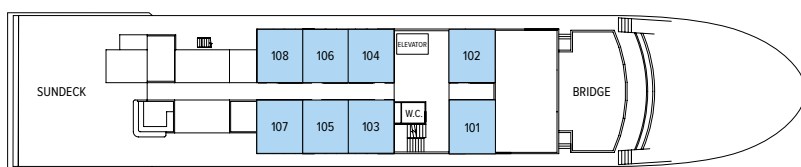

OBSERVATION DECK

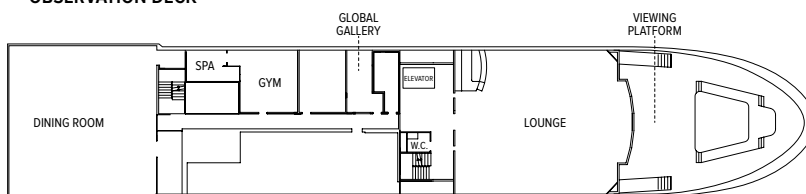

LOUNGE DECK

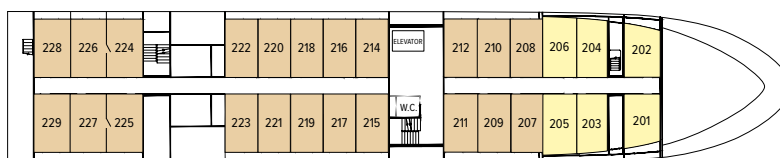

UPPER DECK

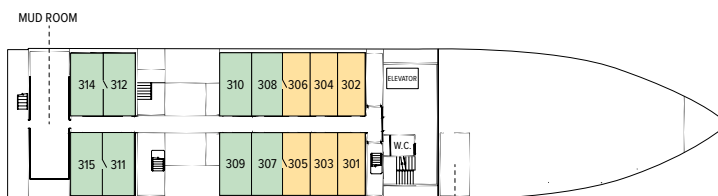

MAIN DECK

- Cat 1 – Main Deck with two portholes
- Cat 2 – Main Deck with two portholes
- Cat 3 – Upper Deck with large window
- Cat 4 – Upper Deck with sliding door & small balcony
- Cat 5 – Observation Deck Suite with large windows



During this voyage you will be visiting out of the way destinations and will be accompanied by an expedition team. Landings and excursions will be made by Zodiac landing craft. This cruise will appeal to the more adventurous and those who enjoy the natural world.



NOBLE CALEDONIA

2 Chester Close, Belgravia, London, SW1X 7BE
+44 (0)20 7752 0000 | info@noble-caledonia.co.uk
www.noble-caledonia.co.uk



All special offers are subject to availability. Our current booking conditions apply to all reservations and are available on request.
Cover image: Red macaws.