

# NATURAL WONDERS OF ALASKA

SPECIAL  
OFFER – SAVE  
**£500**  
PER PERSON

AN EXCLUSIVE CHARTER OF THE NATIONAL GEOGRAPHIC QUEST

12<sup>TH</sup> TO 22<sup>ND</sup> JULY 2024

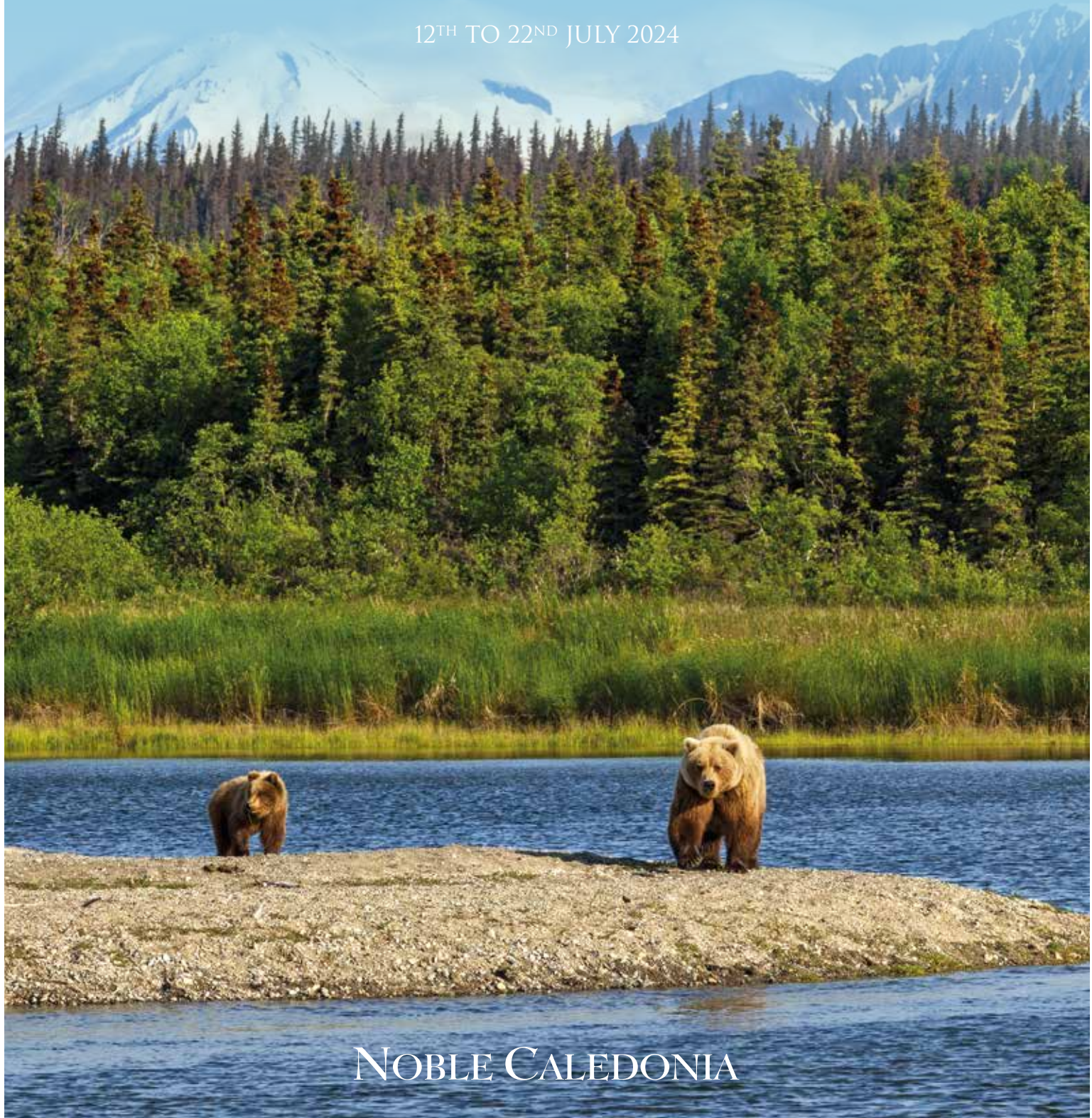

NOBLE CALEDONIA



Humpback whales



There are few places left on earth which offer the traveller as much untamed scenic grandeur as the great land of Alaska. Cliffs soar 3000 feet from the water's edge, spectacular glaciers press into narrow channels and break into thunderous roars and dense forests crowd the coastline and cradle entire ecosystems. Witnessing this vast landscape has a humbling effect on those who journey along the dramatic fjord and coastal scenery and viewing the Alaskan wildlife in their natural habitat is a wonderful experience.

Coastal Alaska can be best appreciated from the deck of a small ship as she weaves her way through the seemingly endless coastal wilderness. This voyage promises to be an expedition in the truest sense, an exciting journey of wildlife discovery and spectacular scenery, which we are offering in conjunction with our associates at Lindblad Expeditions aboard their ideally suited vessel, the 100-passenger National Geographic Quest which we have exclusively chartered for this sailing.

Our voyage is perfectly timed for wildlife viewing and we will follow a flexible course, the day to day itinerary being determined by weather and wildlife sightings. Avoiding the lanes frequented by the big resort ships we will instead be navigating the narrow fjords and passages in the region. Travelling with a maximum of 100 fellow like-minded passengers, you will be able to appreciate the peace and beauty of Alaska, explore in small parties ashore and visit places which the big ships cannot access.

This itinerary which explores the waters between Sitka and Juneau has been custom designed for those looking for an adventure into the heart of Alaska. In addition to seeing the imposing mountains, birdlife, sea life and wildlife that populates the area there will be the opportunity to use kayaks to achieve extra solitude, whilst the Zodiac excursions will take you close to the action. Our itinerary includes a day in Glacier Bay where the number of vessels with access is strictly limited. We will also be able to access the small coves, glaciers and inlets of the Inside Passage which open up to wilderness areas teeming with wildlife and astounding scenery. Gaze skyward in awe of the sheer cliffs of Tracy Arm, listen for the sound of thundering waterfalls and the crack of glaciers calving into the sea, witness the magnificent and diverse wildlife including whales, eagles and, with a bit of luck, brown bears, and visit the small, true Alaskan town of Petersburg, on Mitkof Island. Furthermore, your experience will be enhanced by our onboard team of experts who will accompany you on the Zodiacs, hold daily lectures and briefings and lead guided nature walks ashore.

## Why Lindblad Expeditions & the National Geographic Quest

For this exclusive charter, we have chosen to work with Lindblad Expeditions with whom we have a long association. Lindblad's legacy of exploration in Alaska runs deep: for over 40 years, they have been taking travellers to the most remote corners of the Inside Passage and beyond, and during that time they have discovered new wonders to share and found the shallow, fast-moving channels where whales return to feed year after year and the ancestral trails carved in the forest by lumbering bears. There is no shortage of vessels plying the Alaskan waters. However, we believe the small ship experience is far preferable to cruising on one of the vast resort ships with their 2000 passengers and have therefore chartered the National Geographic Quest for our expedition which explores the many facets of Alaska and which we will be configuring to accommodate just 90 guests for this exclusive sailing.

Unlike the big resort ships that have a set course on the wide channels, the National Geographic Quest will be able to navigate narrow fjords and passages and for a real close up experience we will use the onboard Zodiacs which only very few expedition ships in the region have the required permits to utilise. For those who really wish to experience the magic of the wilderness, to come close to nature and enjoy the serenity of the vast landscape, the National Geographic Quest is the perfect vessel.

## Summer in Alaska

We have chosen the month of July to operate our exclusive charter of the National Geographic Quest. Summer in Southeast Alaska sparkles with boundless energy. The pristine, old-growth rainforests are bursting with green, and we will see the warmest temperatures whilst the longer daylight hours means more chances to spot and observe wildlife. In July, the salmon will start running which lures bald eagles and bears to the streams to feast.

## Joining You On Board

One of the most important aspects of expedition cruising is the knowledge of the expert expedition team that accompanies you on board and for the forays ashore. Joining you on board the National Geographic Quest will be a team of naturalists, one expert per 10 guests who provide talks, guidance ashore, and daily camaraderie. The staff will greatly enhance your experience, sharing special insights into the flora, fauna and geology of Alaska. Each one is not only an expert in their field but passionate about sharing their knowledge and dedicated to seeing that you get the most out of your experience. In addition, a Tlingit interpreter will join us on board to talk about First Nation history and the culture of the area.

### EXPEDITION HIGHLIGHTS

- Travel with just 90 fellow passengers and an expert expedition team.
- In-depth itinerary focused on the Inside Passage with no long sea passages.
- Perfectly timed for wildlife sightings of whales, bears and birdlife including eagles.
- Full day spent in Glacier Bay National Park which is only open to a few vessels.
- Opportunity to kayak and paddleboard.
- Fleet of onboard Zodiacs used for excursions allowing travellers to access best wildlife viewing spots.



## What to Expect

No two expeditions in Alaska are the same and the itinerary is amended based on weather and wildlife sightings. Below are extracts from the logs of previous expeditions in the region aboard the National Geographic Quest.

**Glacier Bay National Park, June 2022:** Beginning at midnight, National Geographic Quest entered the waters of Glacier Bay National Park to journey to the edge of its northernmost boundary. Awakening at the turn of Jaw Point, our guests were greeted with the legendary Johns Hopkins Glacier on full display, showing off its dynamic moraines. As the day progressed, we navigated the park to find whales, mountain goats, sea otters, sea lions, and a myriad of seabirds, including both tufted and horned puffins.

**Tracy Arm, August 2022:** This morning, we woke up to what some would call "Alaskan Sunshine." It was not clear when the sun truly rose due to thick cloud cover and mist. The mountaintops of the sheer granite peaks disappeared into the mist as our guests looked on in awe. Our bow was filled with fascinated passengers when a humpback dove just in front of us. Captain Tim Lyon navigated the icy waters with skill, positioning us just beyond Sawyer Island at the approach to South Sawyer Glacier by the time breakfast was served. At nine o'clock, our first round of Zodiacs cut paths through the ice-filled waters to deliver our guests to the awe-inspiring face of South Sawyer Glacier. Here at the calving birthplace of all this ice, we were able to see where the end of a river of ice meets the ocean. Large calving events sent the thunderous sound of 'Sumdum' echoing down the fjords while seals fled their floating ice to avoid the oncoming waves. Throughout the day, guests were treated to fascinating educational talks by the naturalist staff. Shannon Malone treated us to an education on the development of the old growth forest that we saw popping up all around us as we travelled down the new growth of a fjord. Later in the evening, Jeff Campbell, a professor of ecology, talked us through the species of whales we were likely to encounter throughout our week.





# NATIONAL GEOGRAPHIC QUEST



For our Alaskan adventure we are delighted to have chartered the state-of-the-art National Geographic Quest, one of the latest additions to the National Geographic-Lindblad fleet. Built to accommodate 100 guests, we are limiting passengers numbers to just 90 for this exclusive expedition in order to accommodate some single guests.

Purpose built to explore the North American coast, the design and engineering of the National Geographic Quest were informed by nearly 40 years of experience Lindblad Expeditions has in the region. Her twin boarding platforms, for example, enable the expedition team to load two Zodiacs at once meaning guests can disembark the ship quickly to take advantage of wildlife sightings and maximise time spent exploring ashore. The vessel features a shallow draft, allowing the Captain to navigate the inner reaches and the expedition landing crafts aboard offer opportunities to get even closer to the action and land in remote locations. There are also kayaks on board allowing travellers to paddle into narrow inlets.



Category 4 Cabin



Dining Room



Lounge



## Your Cabin

Cabins aboard the National Geographic Quest are an inviting place to end your day of activity. There are a total of 50 outside cabins on board and each one features two portholes, large windows or balcony. In each cabin, beds can be twin or converted to a Queen. Cabins range in size from 12.6 to 17.3 square metres and feature modern bathrooms, climate controls, hairdryer, Wi-Fi connections and USB ports for mobile devices. You will find organic botanical products in the bathroom.

## Your Dining

Meals are served in the dining room at a single seating with unassigned tables meaning you can dine with whomever you wish. The expedition team will dine alongside guests allowing for opportunities to discuss the highlights of the day and what is to come. The onboard chefs use fresh, local ingredients whenever possible, including locally grown produce, sustainably caught fish, and other local products. An array of fresh fruits and delicious fresh juices are key components of the breakfast buffet, as are fresh vegetables and fish at lunch and dinner. When conditions allow, lighter options may be served outside on the Observation Deck. A selection of drinks including beer and wine are served with lunch and dinner and there is a 24-hour self service beverage station available for tea, coffee and soft drinks.

## Your Space

The spacious public areas include the main dining room and the comfortable lounge which features wrap-around windows for optimal views, a full-service bar and state-of-the-art presentation facilities. The lounge is where guests gather daily for talks and recaps. There is also a small reference library with board games. The vessel features a specially designed open bow and the outside deck has been designed as the perfect wildlife viewing platform which is in close proximity to the lounge allowing for instant access to spontaneous wildlife sightings. Outside there is also a partially covered and furnished sundeck with tables, chairs and lounge chairs for relaxing. To ease the embarkation and disembarkations for the daily activities, the vessel features a mudroom with lockers to store boots and other expedition gear. Another feature of the ship is the spa and fitness centre staffed by the wellness specialist. There is a shop on board stocked with local artisan products. Internet access, laundry service and a ship's doctor are available on board and there is a lift which serves all decks.

## Life On Board

The atmosphere on board is relaxed and informal and focused on the marvellous scenery and wildlife we will be experiencing. Whilst sailing, you can relax on deck with a good book, spend time with the onboard specialists looking for wildlife, relax with a massage in the spa, take part in some morning stretches on deck with the wellness specialist or scan the horizon from the open Bridge with the binoculars provided on board. The vessel carries expedition equipment including eight Zodiac landing craft, kayaks, paddleboards and an underwater video camera. There is a high ratio of crew to passengers and after a day ashore you will return to the comfort and peace of an exceedingly comfortable ship.



## NATIONAL GEOGRAPHIC QUEST DECK PLAN

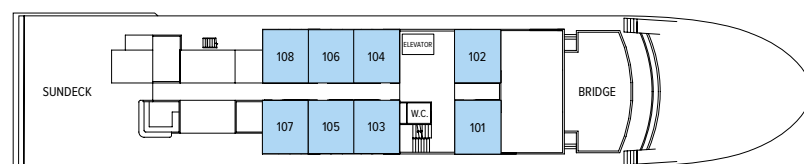

OBSERVATION DECK

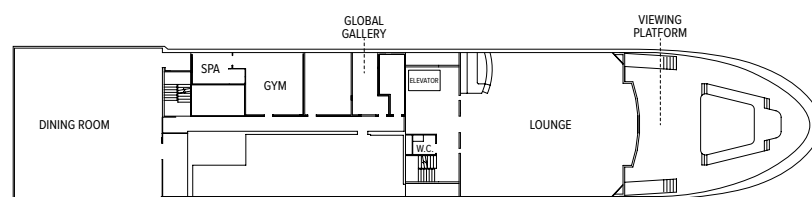

LOUNGE DECK

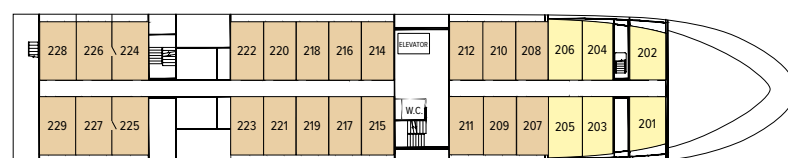

UPPER DECK

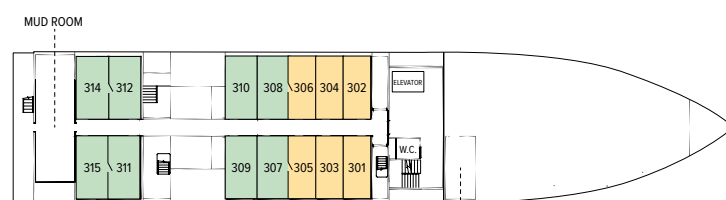

MAIN DECK

- Cat 1 – Main Deck with two portholes
- Cat 2 – Main Deck with two portholes
- Cat 3 – Upper Deck with large window
- Cat 4 – Upper Deck with sliding door & small balcony
- Cat 5 – Observation Deck Suite with large windows



During this voyage you will be visiting out of the way destinations and will be accompanied by an expedition team. Landings and excursions will be made by Zodiac landing craft. This cruise will appeal to the more adventurous and those who enjoy the natural world.



Paddling coves by kayak



Ice Bay, whale watching



Harbour seals

## The Itinerary

**Day 1 London to Seattle, USA.** Fly by scheduled flight. Arrive this evening and transfer to a central hotel for our two night stay. The remainder of the evening is at leisure.

**Day 2 Seattle.** After breakfast in the hotel spend the day and evening exploring Seattle at your own pace. It is a convenient and easy city to explore independently. Maybe take in Pike Place Market, make your way up the Space Needle Observation Tower or take a trip out of the city to the Museum of Flight.

**Day 3 Seattle to Sitka, Alaska.** After breakfast in the hotel transfer to the airport for our flight to Sitka which is situated on the western coast of Baranof Island and overlooking the Pacific Ocean. Arrive this afternoon and transfer to the National Geographic Quest in time for cocktails and an introduction of the vessel staff and crew. Enjoy dinner on board as we sail tonight.

**Day 4 Southeast Alaska's Islands, Bays & Fjords.** Today, nature is our guide as we set forth with the flexibility to take advantage of wildlife and weather conditions. We may stop at an isolated beach to take a closer look at tide pools, beachcomb, and hike along some stunning forest trails. Keep an eye out for old bear tracks worn into the soil as you move from forest to meadow. Sightings of bald eagles are very common in this region. If conditions permit, we will be able to make use of the kayaks, always watching for marine and terrestrial life.

**Day 5 Icy Strait & Inian Islands.** Today we will explore the Inian Islands, where an abundance of Steller sea lions and sea otters reside. We will search for marine mammals in the nutrient-rich waters of Icy Strait and choose the perfect spot around Chichagof Island to hike where sightings of bald eagles are very common.

**Day 6 Glacier Bay National Park.** Spend the day amidst the coves, fjords, tidewater glaciers and majestic mountains of Glacier Bay National Park. We will see glaciers that end abruptly at the water's edge and



observe them "calving" – tons of ice crashing into the sea – accompanied by an exhilarating thunderous sound. Mountain goats scaling the peaks as well as harbour seals, Steller sea lions and puffins are some of the wildlife we may observe. A visit to Tidal Inlet may bring the sight of brown bears lumbering up the hillside. A native Tlingit interpreter will join us on board to share the legends of the area.

**Day 7 Frederick Sound & Chatham Strait.** These waters are prime areas for both killer whales and humpback whales and it is not uncommon to observe their fascinating behaviour – breaching, tail-slapping and variations on feeding – as we fill the deck and listen to the play-by-play from our expert naturalists. We will explore spectacular bays and inlets, following bear trails and salmon streams. Once ashore, we will have the opportunity to walk along a quiet forest trail whilst the still waters are excellent for kayaking, which offers another option for up close exploration.

**Day 8 Petersburg.** Join the onboard naturalists on the lookout for humpback whales as we head towards the small, true Alaskan town of





Petersburg on Mitkof Island. Although the Tlingit and other indigenous groups had been in this area for centuries, it was only after Norwegian Peter Buschmann (after whom the town is named) settled here, starting the first cannery and attracting more immigrants from Scandinavia – hence the nickname “Little Norway” – that a permanent town evolved. Explore a unique Southeast Alaskan ecosystem, the “muskeg”, with stunted trees and carnivorous plants.

**Day 9 Tracy Arm & Fords Terror.** Our wilderness voyage will continue into Tracy or Endicott Arm, both spectacular fjords, with waterfalls cascading from glacially carved walls. See the soaring Dawes or South Sawyer Glacier up close and take a cruise in a Zodiac for an unbeatable view among sculpted icebergs. Keep an eye out for harbour seals, harbour porpoises and Arctic terns.

**Day 10 Juneau to London.** Disembark this morning and transfer to the airport for our scheduled flight to London via Seattle.

**Day 11 London.** Arrive this morning.



Tracy Arm

## Post-cruise Vancouver Extension 21<sup>st</sup> to 24<sup>th</sup> July 2024



Before returning to London we are offering the opportunity to join a two night extension in Vancouver.

### The Itinerary

**Day 1 Juneau to Vancouver, Canada.** Disembark this morning and transfer to the airport for our scheduled flight to Vancouver via Seattle. Arrive this afternoon and transfer to our hotel for a two night stay.

**Day 2 Vancouver.** After breakfast in the hotel a morning city tour will include Chinatown, Gastown and Stanley Park. The rest of the day is free to explore this charming city at your own pace.

**Day 3 Vancouver to London.** Enjoy breakfast in the hotel and a morning at leisure before we transfer to the airport this afternoon for our scheduled flight to London.

**Day 4 London.** Arrive this morning.

### PRICES PER PERSON

Based on double occupancy

**Twin: £995 Single: £1395**

**Price Includes:** Economy class scheduled air travel from Seattle to Vancouver, two nights hotel accommodation in Vancouver with breakfast, Vancouver half day city tour, Noble Caledonia Tour Manager, transfers between airport and hotel.

**Not Included:** Travel insurance, lunches and dinners, Canadian visa.

### PRICES PER PERSON

Based on double occupancy

#### SPECIAL OFFER – SAVE £500 PER PERSON FOR A LIMITED TIME ONLY

Cat	Cabin Description	Brochure Price	Special Offer Price
1	Main Deck with two portholes	£10495	£9995
2	Main Deck with two portholes	£10995	£10495
3	Upper Deck with large window	£11995	£11495
4	Upper Deck with sliding door & small balcony	£12495	£11995
5	Observation Deck Suite with large windows	£12495	£11995
1	Main Deck with two portholes for sole use	£13495	£12995
2	Main Deck with two portholes for sole use	£13995	£13495

**PRICE INCLUDES:** Economy class scheduled air travel • Two nights hotel accommodation in Seattle with breakfast • Seven nights aboard the National Geographic Quest on a full board basis • All non-alcoholic and alcoholic drinks on board (except certain super-premium brands) • Onboard expedition team • Noble Caledonia Tour Managers • Use of onboard kayaks and paddleboards • Shore excursions • Gratuities • Transfers • Unlimited Wi-Fi on board • Port taxes • Airport taxes.

**Not Included:** Travel insurance, lunch and dinner on Day 2, US ESTA.



Bald Eagle, Petersburg



## NOBLE CALEDONIA

2 Chester Close, Belgravia, London, SW1X 7BE  
+44 (0)20 7752 0000 | [info@noble-caledonia.co.uk](mailto:info@noble-caledonia.co.uk)  
[www.noble-caledonia.co.uk](http://www.noble-caledonia.co.uk)



All special offers are subject to availability. Our current booking conditions apply to all reservations and are available on request.  
Cover image: Brown bears.