

NOBLE CALEDONIA

SPECIAL  
OFFER - SAVE  
**£500**  
PER PERSON

A white bird with a blue beak and feet is perched on a branch. The background is a lush green forest. In the foreground, there are red flowers.

# ISLANDS OF THE INDIAN OCEAN

AN EXPEDITION FROM MAURITIUS TO MAHE INCLUDING  
MADAGASCAR ABOARD THE MS CALEDONIAN SKY

9<sup>TH</sup> TO 23<sup>RD</sup> DECEMBER 2020



Here is an extraordinary cruise for those who enjoy the natural world and all its wonders and are looking for the opportunity to escape the British winter. Join us aboard the all-suite MS Caledonian Sky and enjoy the warmth and beauty of the Indian Ocean as she undertakes exactly the type of itinerary that suits her many talents best. With the vessel's purpose built Zodiacs we will land on otherwise inaccessible beaches, explore vast lagoons and coral reefs and encounter some of the most extraordinarily beautiful tropical scenery to be found anywhere in the world.

Sailing from Mauritius we will land on its nearest neighbour, Reunion, a little bit of France in the Indian Ocean and a truly stunning place. We will spend the day exploring its truly awesome and dramatic scenery including the Central Highlands with their spectacularly rugged peaks of dormant volcanoes which cradle huge natural amphitheatres known as cirques. We then continue to Madagascar where we will have three days exploring this incredible verdant and beautiful island. Madagascar is unique; the animals, plants, landscapes and people that make up this thousand mile long island are unlike anywhere else. It is a country that has long remained obscure as a destination and is relatively little known even amongst the most serious of travellers. The long separation from the African mainland has given rise to its amazing number of unique species of flora and fauna.

From Madagascar we will make our way to the Aldabra Island group. Being one of the most difficult places in the world to access and having a lack of freshwater has saved Aldabra from any tourism development and there is no landing strip so the only viable means of reaching this untouched region is by ship. Aldabra is the last breeding ground of the giant tortoise and in addition to seeing some of these endearing creatures you should also encounter dolphins, turtles and whales as well as countless birds including the flightless rail, the last flightless bird in the Indian Ocean.

This expedition really is a veritable feast of beauty, the natural world and island culture. You will witness the bounty of the islands, the wildlife from the giant tortoises of Aldabra to the lemurs of Madagascar and an amazingly prolific birdlife.





Reunion Island waterfalls



Chamelon



Exploring by Zodiac



Praslin, Seychelles

## The Itinerary

**Day 1 London to Mauritius.** Fly by scheduled flight.

**Day 2 Mauritius.** Arrive this morning and transfer to our hotel for an overnight stay. The remainder of the day is at leisure to acclimatise before we meet for dinner in the hotel this evening.

**Day 3 Mauritius.** Enjoy breakfast in the hotel and a morning at leisure. After checking out, lunch will be followed by an island tour which will include the Trou-aux-Cerfs Volcano, the Grand Bassin Lake and Black River Gorges before transferring to the MS Caledonian Sky in the late afternoon. Enjoy welcome drinks and dinner as we sail tonight.

**Day 4 Reunion.** We arrive at breakfast in Reunion where we have a choice of excursions. On a full day tour we will visit the central highlands where spectacularly rugged peaks of dormant or extinct volcanoes cradle huge amphitheatres known as cirques, mountains tower to over 10,000 feet and beautiful waterfalls plummet hundreds of feet. Fields of sugar cane and plantations of tropical fruits, vanilla and all manner of spices perfume the air. We will enjoy views from the Nez des Boueufs and see the Piton de la Fournaise crater. After a creole lunch in a local restaurant, we will visit the "Cite du Volcan" museum. Alternatively join a morning tour to a vanilla plantation in St Andre where we learn about the history and culture of this integral part

of Reunion's heritage. We will also have some free time in St Denis before returning to the MS Caledonian Sky for lunch and an afternoon at leisure before we set sail this evening.

**Day 5 At Sea.** Enjoy a day at sea as we cross to Madagascar. Find a spot on deck to relax or listen to a talk in the Lounge from the experienced expedition team.

**Days 6 & 7 Nosy Mangabe & Masoala National Park, Madagascar.** Spend a day and a half in Antongil Bay. We visit Nosy Mangabe, a 520-hectare island reserve and one of the most diverse areas of virgin rain forest in Madagascar which has also been an important research centre since the mid-1960s when several aye-ayes and lemurs were released into the forest. We will use our Zodiacs to land on the beach next to the forest and organise a series of nature walks looking at the varied trees, plants and ferns and hope to spot chameleon, lizards and black and white ruffed lemur. For the birders we will keep an eye out for Madagascar buzzard, kingfisher and paradise flycatchers. We also visit Madagascar's largest protected area, the Masoala National Park, which comprises of coastal rainforest, flooded forests, marsh and mangroves. Mammal species encountered include the red-ruffed lemur, the red-fronted brown lemur and the ring-tailed mongoose. The park is also home to various species of brightly coloured Mantella frogs

and all manner of extraordinary chameleons. Masoala is also a refuge of the endangered Madagascar red-owl, Madagascar serpent eagle and many endemic bird species. We will run a series of walks for all levels whilst you also have the option to swim off the beach or perhaps visit the local village.

**Day 8 Diego Suarez.** After a morning at sea we will enter dramatic Diego Suarez, a natural harbour with a cosmopolitan mix of inhabitants including Creoles, Indians, Chinese, Comorans and Arabs. After lunch on board there will be a choice of excursion this afternoon. Choose from a city tour visiting the Commonwealth Cemetery and Place Joffre, or the Malagasy Rain Forest at the Mount Amber National Park. Dividing into short and long walk parties we will go in search of lemurs and chameleons as we explore the rain forest. In the towering vegetation, we may spot several species of lemurs and chameleons as well as endemic birds, including parrots.

**Days 9 to 11 Aldabra Island Group.** Spend a relaxing morning at sea before arriving in to the Seychelles where we plan to spend two and a half days at the Aldabra group of islands. Our itinerary will be in the hands of our Expedition Leader and Captain who will monitor the local conditions to ensure we maximise our time here. Whilst our itinerary is flexible we will hope to call at the island of Assumption which was ruthlessly

plundered for its vast deposits of guano in the early 20th century. Happily, peace has returned and the wildlife of rare birds and green turtles are once again in abundance. Our time here will be spent beachcombing, on a nature walk or snorkelling. We also hope to reach Cosmoledo where a huge ring of twelve islands circle a lagoon. Many of the atolls are still to be surveyed and we will explore some of them by Zodiac. This is an important bird area with all three species of booby found in the Seychelles including the last breeding site for the brown booby. Also spot sooty terns and great frigate birds. We will also spend time on Aldabra, the island referred to by Sir Julian Huxley as "One of nature's treasures and should belong to the whole world". Aldabra is unique and every time we call at what is believed to be the world's largest atoll we find something new of interest. Sightings have been made of the extremely rare white throated rail and the atoll is also home to the world's second largest colony of frigate birds and to the largest crab, the coconut crab. Whilst exploring by Zodiac it is difficult to know in which direction to look. The clear blue seas abound with life, the skies are alive with varied birdlife and ashore giant land tortoises forage as they have done for millions of years. We hope to explore Picard Island with a short walk to see some of the thousands of tortoises and numerous robber crabs or swim in the lagoon, a vast 17 mile stretch of shallow clear



Black & white ruffed lemur



Aldabra Island



Giant Tortoise, Aldabra

water. From our Zodiacs we can watch the ever-changing undersea world and snorkel in colourful coral waters.

**Day 12 At Sea.** Spend the day at sea, maybe join a lecture or find a spot on deck.

**Day 13 Alphonse Islands.** There are three islands in the Alphonse group which is located directly south of the Amirantes. As we approach the islands over breakfast you will understand why they are regarded by many to be the most beautiful of the 115 islands in the Seychelles archipelago. On the main island the circular lagoon offers good snorkelling and there are several tracks across the island to enjoy island walks. Spend the morning exploring before returning to the ship for lunch and an afternoon cruising.

**Day 14 Praslin & Grande Soeur.**

This morning we will use Zodiacs to land on Praslin and explore the 'Vallee de Mai', the last remnant of the original high canopied Seychelles palm forest and home to the coco de mer. Walk its paths looking out for the rare black parrot and enjoying its natural beauty. Return to the ship for lunch as we sail the short distance to Grande Soeur, an idyllic uninhabited island. Spend the afternoon walking the island trails which link the white sand beaches and maybe catch sight of some of the islands giant Aldabra tortoises, enjoy a swim or join our final snorkelling opportunity in the turquoise waters.

**Day 15 Mahe to London.**

Disembark this morning and transfer to the airport for our scheduled indirect flight to London. Arrive this afternoon.

**PRICES PER PERSON**

Based on double occupancy

**SPECIAL OFFER – SAVE £500 PER PERSON FOR A LIMITED TIME ONLY**

Deck	Suite Category	Brochure Price	Special Offer Price
Castle	Standard	£8795	£8295
Caledonian	Superior	£8995	£8495
Promenade	Premium	£9195	£8695
Bridge	Deluxe Balcony	£10195	£9695
Promenade	Premium Balcony	£10495	£9995
Promenade	Owners Corner Suite with balcony	£11795	£11295
Castle	Standard for sole use	£10395	£9895
Caledonian	Superior for sole use	£10595	£10095

**PRICE INCLUDES:** Economy class scheduled air travel • Overnight hotel accommodation in Mauritius with breakfast • Dinner on Day 2 • 12 nights aboard the MS Caledonian Sky on a full board basis • House wine, beer & soft drinks with lunch & dinner on board • Shore excursions • Noble Caledonia expedition team • Gratuities • Transfers • Port taxes.

**Not Included:** Travel insurance, visas.

**Post-Cruise Christmas in Mahe Extension**  
23<sup>rd</sup> to 27<sup>th</sup> December 2020



Beau Vallon

If you would like to spend Christmas in the Seychelles before returning to London we are offering a four night hotel extension staying at the Savoy Resort & Spa after disembarking the MS Caledonian Sky. The hotel is located on Beau Vallon, the most popular beach on the island of Mahe.

**The Itinerary**

**Day 1 Mahe, Seychelles.** Disembark the MS Caledonian Sky in Mahe and enjoy a morning island tour and lunch before transferring to our hotel for a four night stay.

**Days 2 to 4 Mahe.** Spend a relaxing three days at leisure to enjoy the hotel facilities, relax on the beach or explore independently with a celebratory Christmas Dinner included on Day 3.

**Day 5 Mahe to London.** After breakfast in the hotel transfer to the airport for your scheduled flight to London. Arrive this afternoon.

**PRICES PER PERSON**

Based on double occupancy

Twin: **£1095** Single: **£1595**

**Price Includes:** Economy class scheduled air travel, four nights hotel accommodation in Mahe with breakfast basis, dinner on Christmas Day, Tour Manager, gratuities, transfers.

**Not Included:** Travel insurance, visas.

# MS CALEDONIAN SKY



Deluxe Balcony Suite



On Deck



The Restaurant

The MS Caledonian Sky is one of our three flag ships and sister vessel to the MS Island Sky and MS Hebridean Sky. All three vessels were built in the same ship yard in Italy at similar times and share the same excellent attributes that make them three of the finest small ships in the world. With a maximum passenger capacity of only 114, a vessel of her size is capable of carrying many more but instead the MS Caledonian Sky has the benefit of unusually large suites, luxuriously appointed public areas and spacious outside decks.



## Your Suite

On board there are 57 exceptionally spacious and well designed suites. The passenger accommodation is arranged over four decks and all suites have outside views. All feature a sitting area and some have private balconies. Each affords considerable comfort with en-suite bathroom featuring a country style wash basin, heated towel rail, vanity unit and walk-in shower and/or bath tub. Facilities in the suites also include walk-in or spacious wardrobes, dressing table

with large mirror and stool or desk, mini-fridge, flat screen television, telephone, programmable electronic safe, hairdryer, assorted Molton Brown toiletries, air-conditioning and heating. Refillable water bottles, dressing gowns and slippers are also provided for your comfort.

## Your Dining

With only one sitting and a maximum of just over 100 passengers, the cuisine on board the MS Caledonian Sky is of a consistent superior quality that befits such a vessel. In keeping with the informal atmosphere on board, when dining you are able to choose your seating arrangements and choice of restaurants at your leisure; whether that be joining a table of four to six other passengers in the elegant à la carte Restaurant or outside buffet-style on the Lido Deck in the evening sunshine. In the main Restaurant, breakfast is served buffet-style, with certain items cooked to order on request. Lunch and dinner menus offer plenty of choice, often reflecting the daily catch and local delicacies. The Welcome and Farewell dinners are a sumptuous five course affair. To enhance your dining experience further a selection of wines is included with both meals. Afternoon tea and pre-dinner canapés take place in either the comfort of the Lounge or out on the Lido Deck when the weather is favourable. Tea and coffee are also available 24 hours a day. Special diets can be catered for with sufficient notice.



Standard Suite



Caledonian Lounge



The Library

## Your Space

The spacious and finely decorated public rooms include a large lounge where briefings are given by the onboard team and talks from Guest Speakers take place. Also in the Lounge is a 24-hour tea and coffee station along with an elegant bar where the onboard pianist plays periodically throughout the day. In addition there is the Lounge on the Panorama Deck which has a bar, library and further spacious seating arrangements, ideal for watching the world go by as you cruise to your next destination. The Travel Library is the perfect place to relax with a good book and is well stocked with reference books pertaining to the destinations the vessel is visiting. A selection of games and devices to access the internet via the ship's satellite can also be found in the library. Access to the ship's satellite Wi-Fi via your own device is complimentary on board (signal strength varies depending on location and demand). Outside there is a rear Lido Deck where meals are served in warm weather under shade. On the top deck there is a further observation and Sun Deck with bar service and comfortable deck furniture for sun bathing or relaxing with a book. There is also a small beauty salon with appointments made on request.

## Your Comfort

The MS Caledonian Sky is equipped with the latest safety, navigation and communications equipment along with roll stabilisers to minimise the ship's motion. During your voyage we hope to offer you the opportunity to visit the Captain and Officers on the Bridge to check the vessel's progress by charts and learn more about your journey. On board you will also find a clinic and Doctor and a lift that serves all decks. When at anchor our nimble Zodiacs will ferry you ashore or, on select cruises, enjoy Zodiac cruises getting you closer to the natural world.

## Your Life On Board

The atmosphere on board is warm and convivial and more akin to a private yacht or country hotel in which you can learn more about the wonderful destinations you are visiting in the company of like-minded people. Dress on board is casual and relaxed and there will be no "black tie" evenings. On board there is a high ratio of crew to passengers. Our friendly crew of 75 are mainly Filipino and Eastern European and our Scandinavian Captains are experienced mariners. After a day ashore you will return to the comfort and peace of a well-run and exceedingly comfortable ship where peace, high quality of service and attention to detail are the order of the day. A little music in the Lounge after dinner, Guest Speakers and informative port briefings from our Expedition Leader or Cruise Director and of course good food, all contribute to make any voyage aboard this wonderful vessel a memorable and joyful experience.

## MS CALEDONIAN SKY DECK PLAN

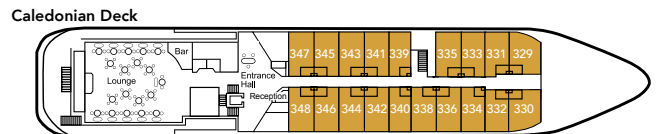
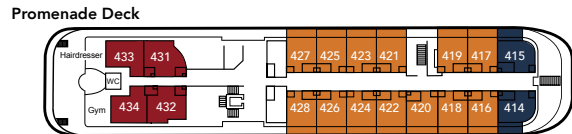
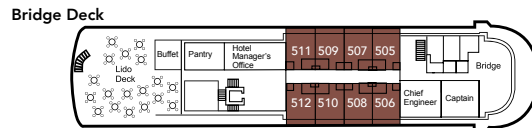
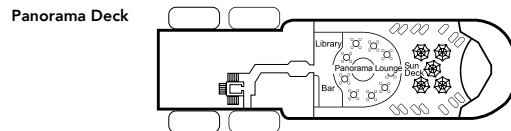
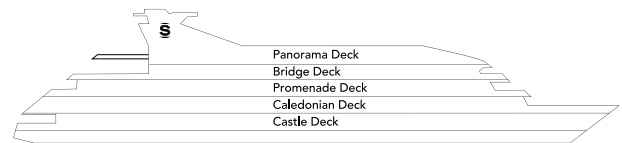

- Standard Suites
- Premium Suites
- Premium Balcony Suites
- Superior Suites
- Deluxe Balcony Suites
- Owner's Corner Suites with Balcony

Please note that all suites on Castle Deck feature a minimum of two portholes.

During this voyage you will be visiting out of the way destinations and will be accompanied by an expedition team. Landings and excursions will be made by Zodiac landing craft. This cruise will appeal to the more adventurous and those who enjoy the natural world.

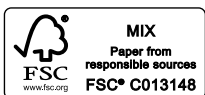

# NOBLE CALEDONIA

2 Chester Close, Belgravia, London, SW1X 7BE  
 +44 (0)20 7752 0000 | info@noble-caledonia.co.uk | noble-caledonia.co.uk

