

SPECIAL
OFFER - SAVE
£500
PER PERSON

ALONG AFRICA'S ATLANTIC COAST

A JOURNEY FROM CAPE TOWN TO GABON
ABOARD THE MS CALEDONIAN SKY
26TH JANUARY TO 11TH FEBRUARY 2021

NOBLE CALEDONIA

Flamingos, Walvis Bay



Join us for this remarkable journey along the south west coast of Africa that promises to be a voyage unlike anything else the MS Caledonian Sky has undertaken in recent years. Leaving bustling Cape Town, we traverse Namibia's bleak but beautiful Skeleton Coast before arriving into the former Portuguese colony of Angola which, with tourism in its infancy, is largely unexplored by all but the most intrepid of travellers. Following a relaxing two days at sea we arrive in the two-island nation of Sao Tome and Principe, famous for its natural beauty and birdlife, for two full days of exploration before reaching our final destination of Gabon.

Some of the most memorable highlights will include exploring the dunes and lagoons of Namibia's Walvis Bay and watching the sky turn pink as tens of thousands of flamingos take flight as well as visiting the quaint colonial towns. From Mocamedes, our first call in Angola, we will venture inland to the Namibe desert with the opportunity to see some of the oldest plants on earth, Welwitschia, and we have an afternoon to explore Luanda, Angola's fascinating capital and once a major city in the Portuguese trading empire.

In Sao Tome & Principe natural wonders abound from beautiful untouched beaches to jungle-covered mountains and the emerald waters are a biodiversity hotspot. Principe still retains the atmosphere of an undiscovered place and, anchoring off beautiful Bon Bon island, we will visit the island's capital city, the world's smallest, and learn about cocoa production on a plantation visit. Finally, we make the short hop to Gabon and the vibrant capital city of Libreville where we have the morning to explore before returning to the UK or, alternatively, you may wish to extend your time here with a two night stay in Pongara National Park.

Without doubt the only comfortable means of experiencing the region's many wonders is by small ship and we are fortunate in having such a special vessel as the MS Caledonian Sky for our exploration. Adding further to your enjoyment will be our experienced onboard team who will be able to inform you of the marine life, birdlife and culture of the regions we will be discovering.



The Itinerary

Day 1 London to Cape Town, South Africa. Fly by scheduled flight.

Day 2 Cape Town. Arrive this morning and transfer to the Table Bay Hotel (or similar). Settle in to your room which will be available upon arrival and spend the rest of the day at leisure to explore independently along the Waterfront or relax and enjoy the hotel facilities. Meet your fellow travellers tonight at a welcome dinner in the hotel.

Day 3 Cape Town. After breakfast, we check out and visit Table Mountain, the city's most celebrated landmark, taking the cable car which offers spectacular views of Devil's Peak, Lion's Head and Signal Hill in the foreground. From the summit, the natural protected area stretching from Signal Hill to Cape Point has been managed under the custodianship of the National Parks Board. This area has one of the highest concentrations of endemic plant

and animal species in any area of its size, containing a staggering 2,285 plant species. Afterwards, enjoy a local lunch before embarking MS Caledonian Sky later in the afternoon. Sail this evening.

Day 4 At Sea. Relax on board as we start our journey along the African coast.

Day 5 Luderitz, Namibia. Sandwiched between the Namibian desert and the South Atlantic,

Luderitz is an isolated settlement and one of the few towns and sheltered harbours on the Namibian coast. First landed by Portuguese mariners in the 15th century, it was not until 1883 when the land was bought by a wealthy merchant, Adolf Luderitz, that the town developed as part of German colonization of the region. Arriving over lunch, we will take an afternoon walking tour to include the Luderitz Museum and the colonial buildings including the



Goerke Haus and Felsenkirche. Nearby, visit the ghost town of Kolmanskop where the first diamonds were found in Namibia in 1908. Sparking a "diamond rush" the town grew in the ensuing years, peaking in the 1920s, until the discovery of richer deposits further south. By the 1960s the population had left and the town is now at the mercy of the weather and encroaching sand dunes. Alternatively, nature lovers can join a local boat tour to Halifax Island and see the resident African penguins as well as seabirds, seals and hopefully humpback whales.

Days 6 & 7 Walvis Bay. Continuing north we spend the morning at sea before arriving at the main coastal town of Walvis Bay, our base for the next day and a half. During our time here we will visit Swakopmund, Namibia's seaside resort on the west coast, and a place of singular charm. It resembles a small Bavarian village nestling between the desert and the sea and enjoys a restful and relaxing atmosphere. The source of Swakopmund's continental vibe is the graceful Art Nouveau buildings many of which, including the Lutheran Church and old railway station, are national monuments. We will also have the opportunity to drive past the imposing sand dunes to the Welwitschia Plains in the Namib-Naukluft Park and we hope to see the prehistoric Welwitschia Mirabilis plants, unique to this region, as we drive through the lunar landscape. Those feeling active may wish to take 4x4 vehicles to Sandwich Harbour, a tidal lagoon located in the

Namib-Naukluft Park surrounded by huge sand dunes which run into the ocean. Here we can experience the isolation and scenery which the Skeleton Coast is famous for. Alternatively, opt to take a cruise in the Walvis Bay Lagoon and see some of the wildlife including flamingos, pelicans, seals and dolphins.

Day 8 At Sea. Spend the day at sea, maybe join a lecture or find a spot on deck as we continue towards Angola.

Day 9 Mocamedes, Angola. Over lunch we arrive at our first call in Angola. The town of Mocamedes was founded in the mid 19th century by the Portuguese but cut off from the rest of the country until the construction of the Namibe railway in 1905 and today it is one of Angola's busiest ports. We venture inland to the Arco Lagoon, a wonderful freshwater oasis located in the Namibe desert bordered by distinctive rock formations and we will also see the nearby rare Welwitschia plants, considered to be some of the oldest on earth at up to 1000 years old. Explore the old city on a short sightseeing tour passing the church of Santo Adriaio and the military fortress before rejoining the MS Caledonian Sky later in the afternoon.

Day 10 Lobito & Benguela. Continue our cruise north this morning and arrive at the port city of Lobito in the early afternoon. The town was created in 1903 as the sea terminal to the Benguela railway, developed to link with the mineral rich regions in Angola and

over the border in the Democratic Republic of Congo. Built by a British concession, the railway became a major source of trade, linking with the port and providing the quickest routes to transport minerals to Europe. Today we travel in some of the original Victorian carriages as we take the train line between Lobito and Benguela. The city of Benguela was founded in 1617 around the Sao Filipe Fortress and was one of the bases for Portuguese expansion in Africa. We explore the town on a sightseeing tour viewing the Portuguese colonial buildings including the Igreja de Populo and the pretty gardens surrounding the town hall.

Day 11 Luanda. After a morning at sea we arrive in the Angolan capital at lunchtime. In the 19th century it was one of the most successful cities in the Portuguese Empire with the port being a major trading centre for ivory, cotton, coffee and cocoa as well as being a key port in the slave trade. With access to vast natural resources including oil and diamonds, the city has recovered from the damages of the Civil War which ran from 1975 to 2002. A city tour will reveal the 16th century San Miguel Fort, the National Museum of Anthropology, Remedios Church, parliament buildings and the unique obelisk of the Agostino Neto Mausoleum dedicated to Angola's first president who fought for independence.

Days 12 & 13 At Sea. Our lecture programme continues as we sail towards the equator and the islands of Sao Tome and Principe.

Day 14 Sao Tome, Sao Tome & Principe. We will experience the benefits of our small ship as we spend a full day on each of the islands of Sao Tome and Principe which are well off the usual tourist route. Fortunately the islands have yet to succumb to mass tourism and we can enjoy their beautiful beaches, tropical rainforests and colonial architecture in relative peace. Colonised by the Portuguese in the 15th century, they were originally a holding centre for slaves en-route to the Americas. However, in the 1800s coffee and cacao plantations grew and by 1908 they became known as the Chocolate Islands being the world's leading producer of cacao. Today, production has slowed but the islands still produce high quality coffee and cacao. We will anchor off Sao Tome and land using the ship's Zodiacs. On a full day tour we will visit one of the plantation houses or "rocas". In the interior we will discover waterfalls and hope to see some of the many orchid species in the botanical gardens and endemic birdlife. Meanwhile in Sao Tome city we will see the National Museum, cathedral and visit the bustling markets.

Day 15 Principe. Today we arrive at the smaller of the two islands at 136 square kilometres and with a population of just 6,000 residents. In 2012 the waters around the island were classified as a UNESCO Biosphere Reserve and from our anchorage off Bom Bom Island we will use ship's Zodiacs to land. For those who wish to explore the island we will take a scenic drive including time in one of the



Sao Tome

world's smallest capital cities of San Antonio and also visit one of the island's cacao plantations at Terreiro Velho. Alternatively, relax on the beach and swim in the clear waters.

Day 16 Libreville, Gabon to London. Disembark this morning by Zodiac and spend some time in the city of Libreville. We will see the Presidential Palace, St Michel Cathedral and the city museum with a great collection of tribal crafts, masks and stone

carvings. After lunch we transfer to the airport for our scheduled indirect flight to London leaving this evening.

Day 17 London. Arrive this morning.

SHIP TO SHORE

Please note that during the voyage we will be at anchor in Sao Tome, Principe and Libreville and will use the vessel's Zodiacs to transfer ashore.

PRICES PER PERSON

Based on double occupancy

SPECIAL OFFER – SAVE £500 PER PERSON FOR A LIMITED TIME ONLY

Deck	Suite Category	Brochure Price	Special Offer Price
Castle	Standard	£10195	£9695
Caledonian	Superior	£10395	£9895
Promenade	Premium	£10495	£9995
Bridge	Deluxe Balcony	£11395	£10895
Promenade	Premium Balcony	£11695	£11195
Promenade	Owners Corner Suite with balcony	£12895	£12395
Castle	Standard for sole use	£13495	£12995
Caledonian	Superior for sole use	£13995	£13495

PRICE INCLUDES: Economy class scheduled air travel • Overnight hotel accommodation in Cape Town with breakfast & dinner • 13 nights aboard the MS Caledonian Sky on a full board basis • House wine, beer & soft drinks with lunch and dinner • Noble Caledonia onboard team • Shore excursions • Gratuities • Transfers • Port taxes.

Not Included: Travel insurance, Angola visa, Gabon visa.

PLEASE NOTE: This cruise visits a number of off the beaten track destinations where you can expect the level of tourism services and health provision to be basic. Visas are required for Angola and Gabon and these need to be obtained prior to departure. Noble Caledonia will provide further information on the application process. This information is correct at the time of printing and, should the information change, we will be in touch with booked passengers with updated guidelines.

Pre-Cruise Cape Town Extension 24th to 27th January 2021

Boulders Beach penguins



The Itinerary

Day 1 London to Cape Town, South Africa. Fly by scheduled flight.

Day 2 Cape Town. Arrive this morning and check into the Table Bay Hotel (or similar) for a two night stay. Spend the rest of the day at leisure.

Day 3 Cape Town. After breakfast join a full day tour to Cape Point, a nature reserve within Table Mountain National Park and a Natural World Heritage Site. Here we walk up to see the lighthouse and rugged coastal scenery at Cape Point as well as stopping at the Cape of Good Hope. As we drive through the reserve, we see the typical fynbos vegetation and may spot antelope or Cape mountain zebra. Afterwards, continue to Simons Town for lunch before visiting Boulders Beach famous for the local resident penguin colony. We return to our hotel later in the afternoon and enjoy an evening at leisure.

Day 4 Cape Town. After breakfast at the hotel, enjoy a morning visit to Kirstenbosch Botanical Gardens and discover the diversity of the Cape flora which should be in full bloom at this time of year. Return to the hotel for an afternoon at leisure before meeting your fellow travellers who arrive today at the welcome dinner. Follow the main itinerary from Day 2.

PRICES PER PERSON

Based on double occupancy

Twin: **£835** Single: **£1095**

Price Includes: Two nights hotel accommodation in Cape Town with breakfast, full day Cape Point tour, half day Kirstenbosch Garden tour, Tour Manager, gratuities, transfers. **Not Included:** Travel insurance.

Post-Cruise Pongara National Park Extension 10th to 13th February 2021



Leatherback turtle

The Itinerary

Day 1 Libreville to Pongara National Park, Gabon.

Disembark this morning and spend some time in the city of Libreville. We will see the Presidential Palace, St Michel Cathedral and the city museum. After lunch transfer

by boat to Pongara National Park and check in to La Baie des Tortues Luth Hotel for a two night stay. Sandwiched between the Komo estuary and the Atlantic Ocean, the pristine beaches here are a nesting ground for hundreds of Leatherback turtles who roam along the beach to lay their eggs which we will discover on a night guided walk along the beach. Meanwhile the animal population includes elephants, red river Hog, buffalo, mangabeys and a variety of birds.

Day 2 Pongara National Park. Spend the day at the park and either relax and make use of the hotel's facilities or partake in one of the activities that will be available to select from including the following: a guided trek, a game drive, a boat excursion in the mangroves, a guided walk to King Denis Village or a swim in the sea.

Day 3 Pongara National Park to London. After a morning at leisure we transfer to Libreville for our scheduled indirect flight to London.

Day 4 London. Arrive this morning.

PRICES PER PERSON

Based on double occupancy

Twin: **£1795** Single: **£2895**

Price Includes: Two nights hotel accommodation at La Baie des Tortues Luth Hotel in Pongara National Park on a full board basis, excursions, Tour Manager, gratuities, transfers. **Not Included:** Travel insurance, Gabon visa.

MS CALEDONIAN SKY



Deluxe Balcony Suite



On Deck



The Restaurant

The MS Caledonian Sky is one of our three flag ships and sister vessel to the MS Island Sky and MS Hebridean Sky. All three vessels were built in the same ship yard in Italy at similar times and share the same excellent attributes that make them three of the finest small ships in the world. With a maximum passenger capacity of only 114, a vessel of her size is capable of carrying many more but instead the MS Caledonian Sky has the benefit of unusually large suites, luxuriously appointed public areas and spacious outside decks.



Your Suite

On board there are 57 exceptionally spacious and well designed suites. The passenger accommodation is arranged over four decks and all suites have outside views. All feature a sitting area and some have private balconies. Each affords considerable comfort with en-suite bathroom featuring a country style wash basin, heated towel rail, vanity unit and walk-in shower and/or bath tub. Facilities in the suites also include walk-in or spacious wardrobes, dressing table

with large mirror and stool or desk, mini-fridge, flat screen television, telephone, programmable electronic safe, hairdryer, assorted Molton Brown toiletries, air-conditioning and heating. Refillable water bottles, dressing gowns and slippers are also provided for your comfort.

Your Dining

With only one sitting and a maximum of just over 100 passengers, the cuisine on board the MS Caledonian Sky is of a consistent superior quality that befits such a vessel. In keeping with the informal atmosphere on board, when dining you are able to choose your seating arrangements and choice of restaurants at your leisure; whether that be joining a table of four to six other passengers in the elegant à la carte Restaurant or outside buffet-style on the Lido Deck in the evening sunshine. In the main Restaurant, breakfast is served buffet-style, with certain items cooked to order on request. Lunch and dinner menus offer plenty of choice, often reflecting the daily catch and local delicacies. The Welcome and Farewell dinners are a sumptuous five course affair. To enhance your dining experience further a selection of wines is included with both meals. Afternoon tea and pre-dinner canapés take place in either the comfort of the Lounge or out on the Lido Deck when the weather is favourable. Tea and coffee are also available 24 hours a day. Special diets can be catered for with sufficient notice.



Standard Suite



Caledonian Lounge



The Library

Your Space

The spacious and finely decorated public rooms include a large lounge where briefings are given by the onboard team and talks from Guest Speakers take place. Also in the Lounge is a 24-hour tea and coffee station along with an elegant bar where the onboard pianist plays periodically throughout the day. In addition there is the Lounge on the Panorama Deck which has a bar, library and further spacious seating arrangements, ideal for watching the world go by as you cruise to your next destination. The Travel Library is the perfect place to relax with a good book and is well stocked with reference books pertaining to the destinations the vessel is visiting. A selection of games and devices to access the internet via the ship's satellite can also be found in the library. Access to the ship's satellite Wi-Fi via your own device is complimentary on board (signal strength varies depending on location and demand). Outside there is a rear Lido Deck where meals are served in warm weather under shade. On the top deck there is a further observation and Sun Deck with bar service and comfortable deck furniture for sun bathing or relaxing with a book. There is also a small beauty salon with appointments made on request.

Your Comfort

The MS Caledonian Sky is equipped with the latest safety, navigation and communications equipment along with roll stabilisers to minimise the ship's motion. During your voyage we hope to offer you the opportunity to visit the Captain and Officers on the Bridge to check the vessel's progress by charts and learn more about your journey. On board you will also find a clinic and Doctor and a lift that serves all decks. When at anchor our nimble Zodiacs will ferry you ashore or, on select cruises, enjoy Zodiac cruises getting you closer to the natural world.

Your Life On Board

The atmosphere on board is warm and convivial and more akin to a private yacht or country hotel in which you can learn more about the wonderful destinations you are visiting in the company of like-minded people. Dress on board is casual and relaxed and there will be no "black tie" evenings. On board there is a high ratio of crew to passengers. Our friendly crew of 75 are mainly Filipino and Eastern European and our Scandinavian Captains are experienced mariners. After a day ashore you will return to the comfort and peace of a well-run and exceedingly comfortable ship where peace, high quality of service and attention to detail are the order of the day. A little music in the Lounge after dinner, Guest Speakers and informative port briefings from our Expedition Leader or Cruise Director and of course good food, all contribute to make any voyage aboard this wonderful vessel a memorable and joyful experience.

MS CALEDONIAN SKY DECK PLAN

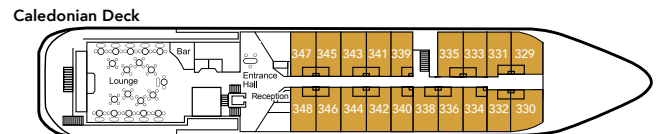
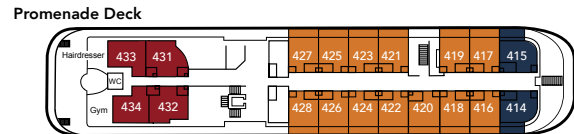
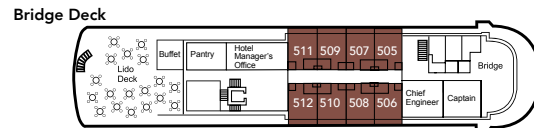
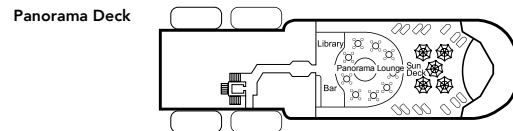
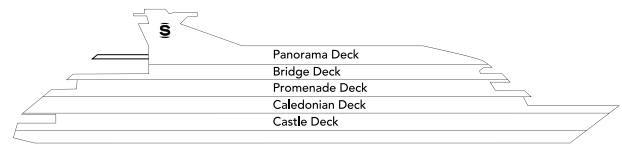

- Standard Suites
- Premium Suites
- Premium Balcony Suites
- Superior Suites
- Deluxe Balcony Suites
- Owner's Corner Suites with Balcony

Please note that all suites on Castle Deck feature a minimum of two portholes.



NOBLE CALEDONIA

2 Chester Close, Belgravia, London, SW1X 7BE
 +44 (0)20 7752 0000 | info@noble-caledonia.co.uk | noble-caledonia.co.uk



All special offers are subject to availability. Our current booking conditions apply to all reservations and are available on request.
 Cover image: Namibia coastline